

# MAIDSTONE JOINT TRANSPORTATION BOARD MEETING

Date: Wednesday 10 July 2019  
Time: 5.00 pm  
Venue: Town Hall, High Street, Maidstone

## Membership:

Councillors Bird, Brindle, Brown, D Burton (Chairman), Carter, Chittenden, Clark, Cooke, Cooper, Cuming, Daley, Hinder, Hotson, Kimmance, Powell, Prendergast, T Sams, Stockell, Wilby and Wilson

*The Chairman will assume that all Members will read the reports before attending the meeting. Officers are asked to assume the same when introducing reports.*

---

## **AMENDED AGENDA**

Page No.

1. Apologies for Absence
2. Notification of Substitute Members
3. Urgent Items
4. Notification of Visiting Members
5. Disclosures by Members and Officers
6. Disclosures of Lobbying
7. To consider whether any items should be taken in private because of the possible disclosure of exempt information
8. Minutes of the Meeting Held on 17 April 2019
9. Presentation of Petitions (if any)
10. Questions and answer session for members of the public (if any)
11. Maidstone Joint Transportation Board Work Programme
12. Reference from Maidstone Borough Council: Implementation of a 20 MPH Speed Limit in Fant
13. 20 MPH Policy Review

---

**Issued on Tuesday 2 July 2019**

**Continued Over/:**

*Alison Broom*

**Alison Broom, Chief Executive**

- 14. Verbal Update - Leeds Langley Relief Road
- 15. **Maidstone Integrated Transport Package (MITP)** 61  
**– APPENDIX 7**
- 16. B2246 Hermitage Lane/A26 Tonbridge Road Project
- 17. Maidstone Highway Works Programme
- 18. **Objections to Traffic Regulation Orders** 62 - 125

## **PUBLIC SPEAKING AND ALTERNATIVE FORMATS**

If you require this information in an alternative format please contact us, call **01622 602899** or email [committee@maidstone.gov.uk](mailto:committee@maidstone.gov.uk).

In order to speak at this meeting, please contact Democratic Services using the contact details above, by 5 p.m. one clear working day before the meeting (i.e. Monday 8 July 2019). If asking a question, you will need to provide the full text in writing. If making a statement, you will need to tell us which agenda item you wish to speak on. Please note that slots will be allocated on a first come, first served basis.

To find out more about the work of the Board, please visit [www.maidstone.gov.uk](http://www.maidstone.gov.uk).



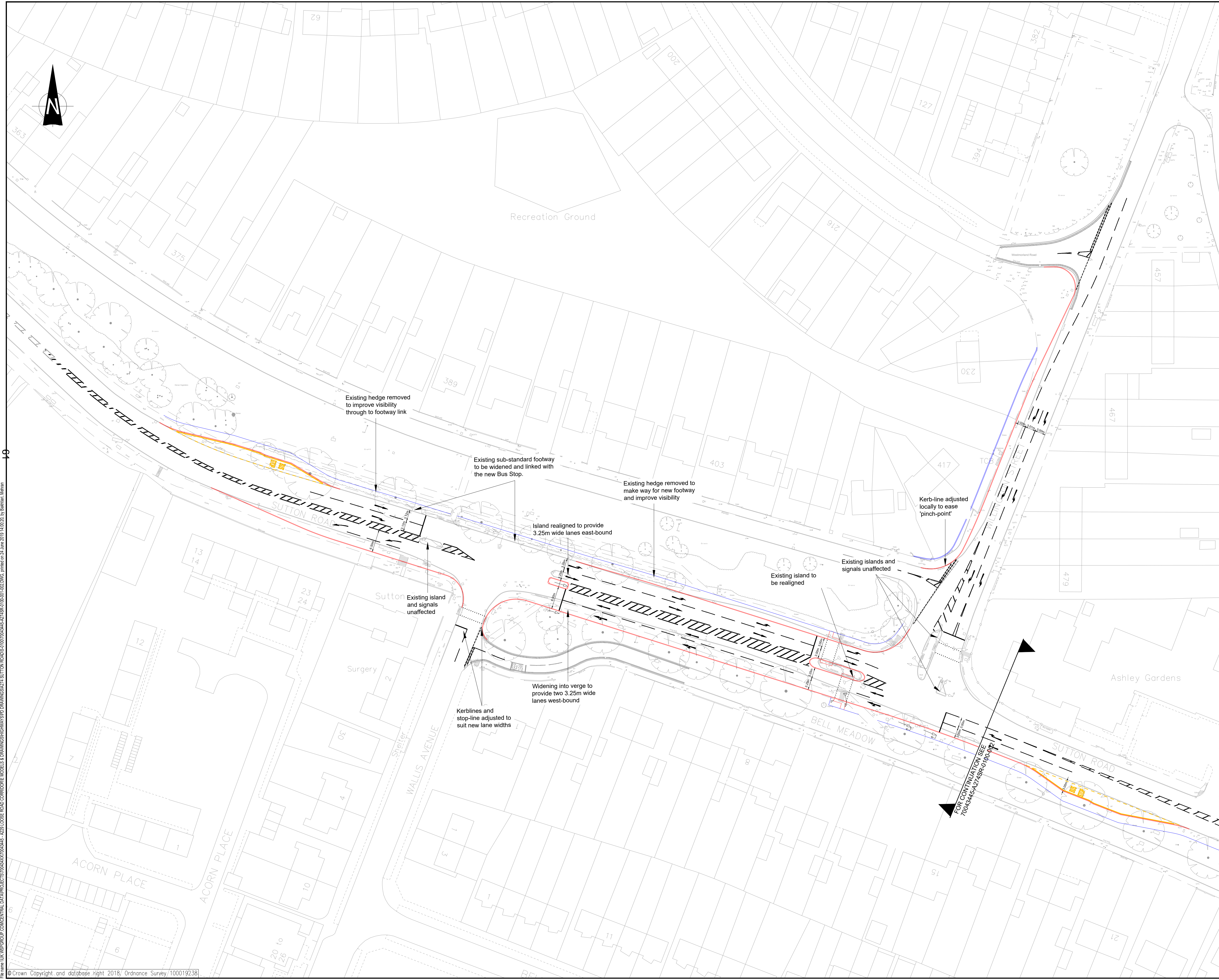

DO NOT SCALE

**NOTES**

- DO NOT SCALE THIS DRAWING.
- ALL DIMENSIONS ARE IN METERS UNLESS OTHERWISE STATED.
- THIS DRAWING SHOULD BE PRINTED IN COLOR.
- THIS DRAWING IS BASED ON TOPOGRAPHICAL SURVEY AND OS BASE DATA SUPPLIED BY KENT COUNTY COUNCIL.
- THIS DRAWING IS BASED ON AN ORIGINAL DESIGN BY AMEY PROVIDED BY KENT COUNTY COUNCIL.
- THIS DRAWING SHALL BE READ IN CONJUNCTION WITH ALL RELEVANT SCHEME DRAWINGS AND SPECIFICATION.
- ALL WORKS TO BE CARRIED OUT IN ACCORDANCE WITH THE DEPARTMENT FOR TRANSPORT SPECIFICATION FOR HIGHWAY WORKS & SUPPLEMENTARY SPECIFICATION DOCUMENTS.
- ALL ROAD MARKINGS AND TRAFFIC SIGN SHALL BE IN ACCORDANCE WITH THE TRAFFIC SIGN MANUAL CHAPTERS 3.4 AND 5.
- ALL PROPOSED KERBS TO TIE IN TO EXISTING KERB LINES AS REQUIRED.
- THE PROPOSED HIGHWAY DESIGN IS SUBJECT TO TRAFFIC MODELING VALIDATION.
- ANY DISCREPANCY WITH THE ORIGINAL SITE SURVEY MUST BE REPORTED IMMEDIATELY TO THE SITE ENGINEER OR KENT COUNCIL PROJECT MANAGER.
- ALL EXISTING ROAD MARKINGS ARE TO BE RENEWED TO TIE IN WITH THE PROPOSED LAYOUT.

**KEY**

- WSP PROPOSED KERB
- WSP PROPOSED BACK OF FOOTWAY
- WSP PROPOSED ROAD MARKINGS
- RELOCATED TRAFFIC SIGNAL
- EXISTING TRAFFIC SIGNAL TO BE RETAINED

1	24/06/2019	MB	REVISED JUNCTION LAYOUT	MB	RB
REV	DATE	BY	DESCRIPTION	CHK	APP

DRAWING STATUS:

S3 - FOR REVIEW

**wsp**

2 Lansdowne Rd, Croydon, CR9 2ER, UK  
T+ 44 (0) 208 263 2413  
wsp.com

CLIENT:

Kent County Council  
1st Floor,  
Invicta House  
Maidstone  
ME14 1XX

PROJECT:

A274 SUTTON ROAD

TITLE:

GENERAL ARRANGEMENT -  
A274 SUTTON ROAD / WILLINGTON STREET JUNCTION

SCALE @ A1:	1:500	CHECKED:	MB	APPROVED:	RB
PROJECT NO:	70043445	DESIGNED:	BV	DRAWN:	BV
DRAWING NO:	70043445-A274SR-0100-001	DATE:	24/06/2019	REV:	1

© WSP UK Ltd

File: \\uk.wspgroup.com\central\_data\projects\70043445\A274SR\DRAWINGS\A274SR-0100-001.dwg, printed on 24 June 2019 14:02:20, by: balakrishna.manna

© Crown Copyright and database right 2018, Ordnance Survey/100019238

Agenda Item 15



## Joint Transportation Board

10<sup>th</sup> July 2019

### Objections to Traffic Regulation Orders

<b>Final Decision-Maker</b>	Strategic Planning and Infrastructure Committee
<b>Lead Head of Service</b>	Jeff Kitson Parking Services Manager
<b>Lead Officer and Report Author</b>	Charlie Reynolds, Operations Engineer
<b>Classification</b>	Public
<b>Wards affected</b>	All

#### Executive Summary

Requests have been received by Parking Services for the introduction of parking restrictions at several locations across the borough. These locations have been surveyed and evaluated to assess the impact on parking provision within each local area where significant parking difficulties were identified.

Proposed orders were advertised, and all comments received during the formal consultation were reviewed and considered.

#### Purpose of Report

Decision

#### This report makes the following recommendations to this Committee:

That the Joint Transportation Board recommends to the Strategic Planning and Infrastructure Committee and Kent County Council as the Highway Authority that:

1. The proposals for West End are not proceeded.
2. The proposals for Pattenden Lane are not proceeded.
3. The proposals for Church Green are proceeded.
4. The proposals for High Street are proceeded.
5. The proposals for Sovereign Way are proceeded.
6. The proposals for Sutton Forge are proceeded.
7. The proposals for Albion Road are proceeded.
8. The proposals for Chantry Road are proceeded.

<b>Timetable</b>	
<b><i>Meeting</i></b>	<b><i>Date</i></b>
Joint Transportation Board	10th July 2019
Strategic Planning and Infrastructure Committee.	10th September 2019

# Objections to Traffic Regulation Orders

## 1. CROSS-CUTTING ISSUES AND IMPLICATIONS

Issue	Implications	Sign-off
<b>Impact on Corporate Priorities</b>	The Strategic Plan objectives are: <ul style="list-style-type: none"> <li>Embracing Growth and Enabling Infrastructure</li> </ul>	Parking Services Manager
<b>Cross Cutting Objectives</b>	The report recommendations support the community by taking into consideration the traffic issues and managing the parking demand.	Parking Services Manager
<b>Risk Management</b>	Consideration must be given to objections and formal letters of support in relation to each proposal. However, this must be balanced against the risks involved in relation to road safety, free flow of traffic, environmental impact and vehicle migration.	Parking Services Manager
<b>Financial</b>	The costs of the order variation and implementation will be met from within the existing Parking Services budget.	Finance Team
<b>Staffing</b>	There will be no impact on staffing.	Parking Services Manager
<b>Legal</b>	Formal orders will need to be made and signed by Kent County Council as the Highway Authority under their statutory powers	Cheryl Parks Mid Kent Legal Services (Planning)
<b>Privacy and Data Protection</b>	Parking Services will hold that data in line with our retention schedules.	Policy and Information Team
<b>Equalities</b>	The public consultation has identified a possible impact in terms on the elderly population's ability to access village amenities as a result of the changes to traffic regulations. Consideration has been given to these comments and the proposals amended accordingly.	Equalities and Corporate Policy Officer
<b>Public Health</b>	None.	Public Health Officer
<b>Crime and Disorder</b>	None.	Parking Services Manager
<b>Procurement</b>	None.	Parking Services Manager

## **2. INTRODUCTION AND BACKGROUND**

- 2.1 Requests have been received by Parking Services for the introduction of parking restrictions at several locations across the borough. Kent County Council and Maidstone Borough Council Officers met Marden Parish Council to discuss the issues raised.
- 2.2 These locations have been surveyed and evaluated to assess the impact on parking provision within each local area where significant parking difficulties were identified.
- 2.3 Proposed orders were advertised, and all comments received during the formal consultation were reviewed and considered.
- 2.4 This report identifies those proposals where objections have been received.
- 2.5 During the Consultation Period, Parking Services received 2 objections and 4 comments in respect of West End in Marden. 8 Objections and 7 Comments in respect of Pattenden Lane, we also received 2 letters of support. 2 objections were also received in respect of Marden proposals in general.
- 2.6 A summary of the proposed action for each proposal is summarised in the table below.

<b>Proposed Restriction in;</b>	<b>Recommendation</b>
1. West End (Marden)	Not to proceed with the proposal.
2. Pattenden Lane (Marden)	Not to proceed with the proposal.
3. Church Green (Marden)	To proceed with the proposal.
4. High Street (Marden)	To proceed with the proposal.
5. Sovereign Way (Marden)	To proceed with the proposal.
6. Sutton Forge (Marden)	To proceed with the proposal.
7. Albion Road (Marden)	To proceed with the proposal.
8. Chantry Road (Marden)	To proceed with the proposal.

- 2.7 A full summary of the consultation results are contained in Appendix B.

---

## **3. AVAILABLE OPTIONS**

- 3.1 To accept the recommendations will recognise objections made in relation to specific proposals and will allow orders to be implemented to regulate parking to reduce difficulties.
- 3.2 Rejecting the recommendations will result in some orders not being implemented, which are intended to regulate parking to reduce identified difficulties.
- 3.3 To make the orders as advertised would not take account of comments received during formal consultation.

---

#### **4. PREFERRED OPTION AND REASONS FOR RECOMMENDATIONS**

- 4.1 To proceed with the recommendations will recognise objections made in relation to specific proposals and will allow orders to be implemented to regulate parking to reduce difficulties.
- 4.2 Appendix A provides details of the proposed orders receiving objection, to the Kent County Council (Various Roads, Borough of Maidstone) (Waiting restrictions and Street Parking Places) (Variation No 22) Order 2019 with a summary of the objections and the relevant recommendations.
- 4.3 Appendix B provides a summary of the consultation and responses.
- 4.4 Appendix C provides maps of each of the proposals.

---

#### **5. RISK**

- 5.1 As part of the legal process to amend Traffic Regulation Orders, formal consultation was undertaken and any objections received considered. As this is a legislative process, the risks associated to legal challenge are reduced.

---

#### **6. CONSULTATION RESULTS AND PREVIOUS COMMITTEE FEEDBACK**

- 6.1 Correspondence was sent to statutory and non-statutory consultees; Public Notices were also posted in the affected roads.
- 6.2 A Public Notice formally advertising the orders for The Kent County Council (Various Roads, Borough of Maidstone) (Waiting restrictions and Street Parking Places) (Variation No 22) Order 2019 were published in the Local Press during the week ending Friday 1st March 2019.
- 6.3 Full details were contained in the draft orders which, together with a copy of the Public Notices, site plans and a statement of the Council's reasons for proposing to make the orders were placed on deposit at the Main Reception, County Hall, Maidstone, Kent, ME14 1XX, and at the Gateway Reception, King Street, Maidstone, ME156JQ.
- 6.4 Proposed orders were advertised, and all comments received during the formal consultation were reviewed and considered.

---

#### **7. NEXT STEPS: COMMUNICATION AND IMPLEMENTATION OF THE DECISION**

- 7.1 The recommendations of the Joint Transportation Board will be presented to the Strategic Planning and Infrastructure Committee for consideration on



10<sup>th</sup> September 2019 and thereafter the Traffic Regulation Order amended accordingly.

- 7.2 The objectors will be informed of the outcome.
- 7.3 Once the formal process has been completed the Has Made Order will be submitted to Kent County Council for sealing.
- 7.4 After the Order has been sealed then the restrictions will then be implemented at each location.

---

## **8. REPORT APPENDICES**

- 8.1 The following documents are to be published with this report and form part of the report:

Appendix A: Proposed orders receiving objections and recommendations.

Appendix B: Consultation summary of responses.

Appendix C: Maps of each the proposal.

---

## **9. BACKGROUND PAPERS**

None

## Appendix A

Proposed orders receiving objection to The Kent County Council (Various Roads, Borough of Maidstone) (Waiting restrictions and Street Parking Places) (Variation No 22) Order 2019.

### **Roads in Marden in the Borough of Maidstone; WEST END;**

2 objections and 4 comments were received on the grounds that the change of restriction times would have an impact on business's and events that current take place in the Congregational Chapel and this would inconvenience people attending activities.

It will therefore have a direct influence on customer levels; the dispersion of vehicles into other surrounding streets would also have a detrimental effect on the mainly residential streets.

A full summary of the consultation results are contained in Appendix B.

**Recommendation:** To recommend to the Joint Transportation Board not to proceed with the proposal.

---

### **Roads in Marden in the Borough of Maidstone; PATTENDEN LANE;**

8 Objections and 7 comments received on the grounds that the that the imposition of a 24 hour restriction would have a significant detrimental impact upon the running of business's in the area, and impact upon customers and patrons of the business they could also increase safety issues, Currently vehicles parking in this area act as a natural traffic calming.

It will therefore have a direct influence on customer levels; the dispersion of vehicles into other surrounding streets would also have a detrimental effect on the mainly residential streets.

We also received 2 letters of support.

A full summary of the consultation results are contained in Appendix B.

**Recommendation:** To recommend to the Joint Transportation Board not to proceed with the proposal.

**Roads in Marden in the Borough of Maidstone MARDEN GENERAL;**

2 Objections received on the grounds that the proposals will directly harm local businesses who rely on customers being able to park nearby and conveniently. This is particularly so in relation to the elderly. It is very dangerous in the present economic climate to hurt local businesses who are struggling to compete with town centres but above all with online shopping, local villages rely on nearby facilities which are convenient to pop out to buy limited amounts of goods and services.

We also received 1 letter of support.

A full summary of the consultation results are contained in Appendix B.

**Recommendation:** To recommend to the Joint Transportation Board not to proceed with the proposals for Pattenden Lane and West End as detailed above.

-----

Variation 22

**SUTTON FORGE**





Objection	Comment	Support 12	Recommend to proceed with the proposal and make the Order
-----------	---------	------------	---

Name	Address	Comments	Response
Support		<p>As a resident of Sutton Forge, I would like to write in support of the above application.</p> <p>It will be super not to have commuters waking us up early in the morning and not having to put up with inconsiderate parking.</p> <p>It will be great for others to be able to park and use the village amenities.</p>	<p>Thank you for your correspondence received in relation to the above proposed parking restrictions.</p> <p>Your support has been recorded and will be considered as part of the traffic regulation process.</p> <p>I regret we are unable to reply to each individual comment received, however once all replies have been collated a report may be presented to the Joint Transportation Board at their next scheduled meeting with our recommendations, the board will provide their comments on the proposals.</p> <p>Thank you once again for taking the time to record your comments and I look forward to being able to update you on the progress of the proposed parking order in the near future.</p>
Support		<p>I note the posted Notice with regards to the parking restrictions in the cul-de-sac known as Sutton Forge, Marden.</p> <p>I wholly support the restrictions. Our road has been utilised by non-residents as a commuting car park for too long. The road has developed tram lines (indentations into</p>	<p>Thank you for your correspondence received in relation to the above proposed parking restrictions.</p> <p>Your support has been recorded and will be considered as part of the traffic regulation process.</p>



		<p>the tarmac) by their constant use and this begins as early as 5:30am every day for the whole day with some drivers returning from the station late into the evening.</p> <p>I am totally in support and thank you.</p>	<p>I regret we are unable to reply to each individual comment received, however once all replies have been collated a report may be presented to the Joint Transportation Board at their next scheduled meeting with our recommendations, the board will provide their comments on the proposals.</p> <p>Thank you once again for taking the time to record your comments and I look forward to being able to update you on the progress of the proposed parking order in the near future.</p>
Support		<p>I have been informed of the proposed parking restrictions in Sutton Forge, Marden and am totally in favour of this order due to the disturbance of present parking.</p>	<p>Thank you for your correspondence received in relation to the above proposed parking restrictions.</p> <p>Your support has been recorded and will be considered as part of the traffic regulation process.</p> <p>I regret we are unable to reply to each individual comment received, however once all replies have been collated a report may be presented to the Joint Transportation Board at their next scheduled meeting with our recommendations, the board will provide their comments on the proposals.</p> <p>Thank you once again for taking the time to record your comments and I look forward to being able to update you on the progress of the proposed parking order in the near future.</p>
		<p>On 28<sup>th</sup> February 2019 you posted the relevant notice with regards to a revision of car parking restrictions in Sutton Forge, Marden. As residents, we are fully in favour of</p>	<p>Thank you for your correspondence received in relation to the above proposed parking restrictions.</p>

Support	[REDACTED]	these proposals.	<p>Your support has been recorded and will be considered as part of the traffic regulation process.</p> <p>I regret we are unable to reply to each individual comment received, however once all replies have been collated a report may be presented to the Joint Transportation Board at their next scheduled meeting with our recommendations, the board will provide their comments on the proposals.</p> <p>Thank you once again for taking the time to record your comments and I look forward to being able to update you on the progress of the proposed parking order in the near future.</p>
Support	[REDACTED]	<p>Having read the relevant notices posted with regards to a revision of car parking restrictions in Sutton Forge, Marden.</p> <p>I am in favour of the proposals.</p>	<p>Thank you for your correspondence received in relation to the above proposed parking restrictions.</p> <p>Your support has been recorded and will be considered as part of the traffic regulation process.</p> <p>I regret we are unable to reply to each individual comment received, however once all replies have been collated a report may be presented to the Joint Transportation Board at their next scheduled meeting with our recommendations, the board will provide their comments on the proposals.</p> <p>Thank you once again for taking the time to record your comments and I look forward to being able to update you on the progress of the proposed parking order in the near future.</p>

  Support		<p>With reference to the relevant notice regarding revision of car parking restrictions in Sutton Forge, Marden. As residents we are fully in favour of the proposals.</p>	<p>Thank you for your correspondence received in relation to the above proposed parking restrictions.</p> <p>Your support has been recorded and will be considered as part of the traffic regulation process.</p> <p>I regret we are unable to reply to each individual comment received, however once all replies have been collated a report may be presented to the Joint Transportation Board at their next scheduled meeting with our recommendations, the board will provide their comments on the proposals.</p> <p>Thank you once again for taking the time to record your comments and I look forward to being able to update you on the progress of the proposed parking order in the near future.</p>
  Support		<p>Yesterday you posted the relevant notice with regards to a revision of car parking restrictions in Sutton Forge, Marden. As residents we are fully in favour of the proposals.</p>	<p>Thank you for your correspondence received in relation to the above proposed parking restrictions.</p> <p>Your support has been recorded and will be considered as part of the traffic regulation process.</p> <p>I regret we are unable to reply to each individual comment received, however once all replies have been collated a report may be presented to the Joint Transportation Board at their next scheduled meeting with our recommendations, the board will provide their comments on the proposals.</p> <p>Thank you once again for taking the time to record your comments and I look forward to</p>

			being able to update you on the progress of the proposed parking order in the near future.
Support		With reference to the above we are fully in favour of your proposals. Our daughter lives in Sutton Forge and we often feel when visiting her that we should be able to park easily and this would help enormously as we are both in our 80s.	<p>Thank you for your correspondence received in relation to the above proposed parking restrictions.</p> <p>Your support has been recorded and will be considered as part of the traffic regulation process.</p> <p>I regret we are unable to reply to each individual comment received, however once all replies have been collated a report may be presented to the Joint Transportation Board at their next scheduled meeting with our recommendations, the board will provide their comments on the proposals.</p> <p>Thank you once again for taking the time to record your comments and I look forward to being able to update you on the progress of the proposed parking order in the near future.</p>
Support		Recently you posted the relevant notice with regards to a revision of car parking restrictions in Sutton Forge, Marden. As residents we are fully in favour of the proposals.	<p>Thank you for your correspondence received in relation to the above proposed parking restrictions.</p> <p>Your support has been recorded and will be considered as part of the traffic regulation process.</p> <p>I regret we are unable to reply to each individual comment received, however once all replies have been collated a report may be presented to the Joint Transportation Board at their next scheduled meeting with our recommendations, the board will provide</p>



			<p>their comments on the proposals.</p> <p>Thank you once again for taking the time to record your comments and I look forward to being able to update you on the progress of the proposed parking order in the near future.</p>
Support		<p>I would like to add my support to the proposal to add yellow lines to each side of Sutton Forge, Marden, as per the proposals shared on signage outside my house.</p>	<p>Thank you for your correspondence received in relation to the above proposed parking restrictions.</p> <p>Your support has been recorded and will be considered as part of the traffic regulation process.</p> <p>I regret we are unable to reply to each individual comment received, however once all replies have been collated a report may be presented to the Joint Transportation Board at their next scheduled meeting with our recommendations, the board will provide their comments on the proposals.</p> <p>Thank you once again for taking the time to record your comments and I look forward to being able to update you on the progress of the proposed parking order in the near future.</p>
Support		<p><b>SUTTON FORGE</b></p> <p>As a resident of this road I welcome the proposed restriction of commuter parking 7:00am to 7:00pm. This has been wearing out the asphalt on one side but the main problem has been the affect it has on the village community. Older people from lower Marden cannot come up to use the shops and in particular the chemist for their prescriptions.</p>	<p>Thank you for your correspondence received in relation to the above proposed parking restrictions.</p> <p>Your support has been recorded and will be considered as part of the traffic regulation process.</p> <p>I regret we are unable to reply to each individual comment received, however once all replies have been collated a report may be</p>

		<p>VESTRY HALL</p> <p>The timing for this area was kindly changed by yourselves before as there are a number of events when we are driving old people to attend community lunches to and from the hall 12 noon to 2:00pm. Please can this period not be in a restricted time and similarly as many funeral events after the church service have caterers turning up at 2:00pm to 3:00pm to deliver refreshments.</p>	<p>presented to the Joint Transportation Board at their next scheduled meeting with our recommendations, the board will provide their comments on the proposals.</p> <p>Thank you once again for taking the time to record your comments and I look forward to being able to update you on the progress of the proposed parking order in the near future.</p> <p>Thank you letter of support and comments received.</p> <p>Maidstone Borough Council have been working closely with the Parish after they conducted extensive consultation within the Parish in an effort manage the parking demand in Marden, discussions then were held with the Parish, Local Councillor's and KCC and it was agreed to formally consult with residents and to put forward the current proposals.</p> <p>I hope this information is of assistance however if you wish to discuss the matter further please do not hesitate in contacting me.</p>
Support		<p>I refer to the above proposal and would like to provide our full support for this initiative. This is a very welcome proposal as it will allow those visiting the village to park and more importantly for us, help to prevent potential accidents due to congestion, obstruction and visibility.</p>	<p>Thank you for your correspondence received in relation to the above proposed parking restrictions.</p> <p>Your support has been recorded and will be considered as part of the traffic regulation process.</p> <p>I regret we are unable to reply to each individual comment received, however once</p>

			<p>all replies have been collated a report may be presented to the Joint Transportation Board at their next scheduled meeting with our recommendations, the board will provide their comments on the proposals.</p> <p>Thank you once again for taking the time to record your comments and I look forward to being able to update you on the progress of the proposed parking order in the near future.</p>
--	--	--	--

## WEST END

Objection 2	Comment 4	Support	
-------------	-----------	---------	--

Name	Address	Comments	Response
Comment		<p>I am concerned that by changing the parking restriction you may do two things:</p> <ol style="list-style-type: none"> <li>1. Affect our business. Currently the restriction is 9:30am to 10am which allows our customers to park on the road when visiting the pub at any other time. The new restriction impacts on our business in as much as we have worked hard to encourage walking groups who will leave from the pub at 10am/10:30am and return for lunch and leave at approximately 2:30pm. We serve coffee and breakfast too from 8:30am but the majority of customers eat after 10am.</li> <li>2. I can only assume that the borough council and KCC are short of work and have some cash to spend! The confusion that these changes in the village will cause is ridiculous. All the locals know when they can park to do shopping and there seems to me that there is no good reason to change the times. If this change is implemented, we will have to reprint our menus and change the notices of our website. Who will pay for that?</li> </ol> <p>In my opinion a better proposal may be a time limit. This way you could leave the timing as they are but also restrict the length of time people can park in an area. Perhaps a 4 to 6 hour only parking between the hours of 9am and 5pm. Perhaps you could even remove the half hour parking restriction. I would suggest that this would be easier to</p>	<p>Thank you for your correspondence received in relation to the above proposed parking restrictions.</p> <p>Your comments have been recorded and will be considered as part of the traffic regulation process.</p> <p>I regret we are unable to reply to each individual comment received, however once all replies have been collated a report may be presented to the Joint Transportation Board at their next scheduled meeting with our recommendations, the board will provide their comments on the proposals.</p> <p>Thank you once again for taking the time to record your comments and I look forward to being able to update you on the progress of the proposed parking order in the near future.</p> <p>-----</p> <p>Thank you for your correspondence received in relation to the above Proposed parking restrictions.</p> <p>Maidstone Borough Council have been working closely with the Parish after they conducted extensive consultation within the Parish in an effort manage the parking demand in Marden, discussions then were</p>



		<p>monitor as it merely requires a drive through video and a return follow up the allotted time later.</p> <p>We are happy to help you with the consultation and even host a meeting if required.</p>	<p>held with the Parish, Local Councillor's and KCC and it was agreed to formally consult with residents and to put forward the current proposals.</p> <p>During the formal consultation period we received your correspondence raising objection on the grounds that, the new proposal could affect your Business</p> <p>The new proposals are being put forward to provide consistency and designed to have the least inconvenience to residents with the new operational time of 11:00 – 11:30am, Monday – Friday which would allow residents and visitors to park outside of these times, there is also unrestricted parking in the vicinity of some parts of Sovereigns Way and Barrel Arch Close.</p> <p>Disabled drivers who have a Blue Badge can park for 3 hours where there is a parking restriction, other than a loading restriction.</p> <p>I hope this information is of assistance however if you wish to discuss the matter further please do not hesitate in contacting me.</p>
<p>Comment</p>		<p>I am writing to you about the 9:30 – 10:00am current single line restriction time for Sovereigns Way to Lucks Way and West End in Marden being changed to 11:00am – 11:30am Monday to Friday. Are you aware that there are two "Seniors Keep Fit" classes held in the Congregational Chapel each Thursday morning from 10:30am until 12:30pm? As a lot of members of the two classes need to park their cars outside the Chapel – what do we do? If this</p>	<p>Thank you for your correspondence received in relation to the above proposed parking restrictions.</p> <p>Your comments have been recorded and will be considered as part of the traffic regulation process.</p> <p>I regret we are unable to reply to each individual comment received, however once</p>

		<p>restriction is applied, a lot of members will not be able to attend the classes anymore. I look forward to your early reply.</p> <p>-----</p> <p>You asked me to write to you again following our conversation on 3.5.19 re: the above proposed parking restrictions. I go to a senior citizen 'keep fit' class (at my doctor's suggestion) every Thursday morning from 10.30a.m. until 11.30a.m. I am unable to walk to the Congregational Church and your previous letter to me told me that there is a car park behind the Church - this is not so, a lot of houses have been built there, and now there are only three car parking spaces, one of which is for the Church Pastor and the other two are taken up by the physiotherapist etc who takes the class! If I am unable to park outside on the 'yellow line' I will no longer be able to attend the keep fit sessions (along with several other O.A.P.'s!) I do not qualify for a 'Blue Badge' even though I have had 3 knee replacements! I hope this helps to clarify the situation.</p>	<p>all replies have been collated a report may be presented to the Joint Transportation Board at their next scheduled meeting with our recommendations, the board will provide their comments on the proposals. Thank you once again for taking the time to record your comments and I look forward to being able to update you on the progress of the proposed parking order in the near future.</p> <hr/> <p>Thank you for your correspondence received in relation to the above Proposed parking restrictions. Maidstone Borough Council have been working closely with the Parish after they conducted extensive consultation within the Parish in an effort manage the parking demand in Marden, discussions then were held with the Parish, Local Councillor's and KCC and it was agreed to formally consult with residents and to put forward the current proposals. During the formal consolation period we received your correspondence raising objection on the grounds that, the new proposal could affect your Business The new proposals are being put forward to provide consistency and designed to have the least inconvenience to residents with the new operational time of 11:00 – 11:30am, Monday – Friday which would allow residents and visitors to park outside of these times. Disabled drivers who have a Blue Badge can</p>
--	--	--	--

			<p>park for 3 hours where there is a parking restriction, other than a loading restriction. I have been advised that there are a number of off-road parking spaces to the rear of the Chapel and it has a rear entrance. There is also unrestricted parking in the vicinity of some parts of Sovereigns Way and Barrel Arch Close.</p> <p>I hope this information is of assistance however if you wish to discuss the matter further please do not hesitate in contacting me.</p>
<p>██████████</p> <p>Objection</p>	<p>██████████</p>	<p>I would like to object to the proposed changes to the parking along Goudhurst Road as I use the Congregational Church for the exercise class and choir practise, and it would be inconvenient not to park outside.</p>	<p>Thank you for your correspondence received in relation to the above proposed parking restrictions.</p> <p>Your comments have been recorded and will be considered as part of the traffic regulation process.</p> <p>I regret we are unable to reply to each individual comment received, however once all replies have been collated a report may be presented to the Joint Transportation Board at their next scheduled meeting with our recommendations, the board will provide their comments on the proposals.</p> <p>Thank you once again for taking the time to record your comments and I look forward to being able to update you on the progress of the proposed parking order in the near future.</p> <hr/> <p>Further to your letter of objection received in relation to the above Proposed parking</p>

			<p>restrictions.</p> <p>Maidstone Borough Council have been working closely with the Parish after they conducted extensive consultation within the Parish in an effort manage the parking demand in Marden, discussions then were held with the Parish, Local Councillor's and KCC and it was agreed to formally consult with residents and to put forward the current proposals.</p> <p>During the formal consultation period we received your correspondence raising objection on the grounds that, the new proposal could affect your Business</p> <p>The new proposals are being put forward to provide consistency and designed to have the least inconvenience to residents with the new operational time of 11:00 – 11:30am, Monday – Friday which would allow residents and visitors to park outside of these times.</p> <p>Disabled drivers who have a Blue Badge can park for 3 hours where there is a parking restriction, other than a loading restriction.</p> <p>I have been advised that there are a number of off-road parking spaces to the rear of the Chapel and it has a rear entrance. There is also unrestricted parking in the vicinity of some parts of Sovereigns Way and Barrel Arch Close.</p> <p>Therefore I respectfully request that you consider withdrawing your objection which would enable us to continue with the proposal and if you are agreeable to withdrawing your</p>
--	--	--	---

			objection this must be in writing, or if you wish to discuss the matter further please do not hesitate in contacting me.
Comment		<p>I see that changes in the time for the yellow band restrictions are proposed in Marden. I understand that these are necessary but if the restriction outside the Congregational Church, West End could be left at 09:30 – 10:00am and not altered it would be a great help. I run several exercise classes for retired people in the Congregational Church. Some of them are quite frail and need to be able to park close by. The classes are from 10:30 – 12:30pm so if the restrictions were changed to 1-11:30am as proposed there would be problems with where to park for the class attenders.</p> <p>I'm sure you agree that is important to keep the older members of the community as physically mobile as possible so if the parking restrictions could be left as they are this would aid that process.</p>	<p>Thank you for your correspondence received in relation to the above proposed parking restrictions. Your comments have been recorded and will be considered as part of the traffic regulation process.</p> <p>I regret we are unable to reply to each individual comment received, however once all replies have been collated a report may be presented to the Joint Transportation Board at their next scheduled meeting with our recommendations, the board will provide their comments on the proposals.</p> <p>Thank you once again for taking the time to record your comments and I look forward to being able to update you on the progress of the proposed parking order in the near future.</p> <p>-----</p> <p>Thank you for your correspondence received in relation to the above Proposed parking restrictions.</p> <p>Maidstone Borough Council have been working closely with the Parish after they conducted extensive consultation within the Parish in an effort manage the parking demand in Marden, discussions then were held with the Parish, Local Councillor's and KCC and it was agreed to formally consult with</p>

			<p>residents and to put forward the current proposals.</p> <p>During the formal consolation period we received your correspondence raising objection on the grounds that, the new proposal could affect your Business</p> <p>The new proposals are being put forward to provide consistency and designed to have the least inconvenience to residents with the new operational time of 11:00 – 11:30am, Monday – Friday which would allow residents and visitors to park outside of these times.</p> <p>Disabled drivers who have a Blue Badge can park for 3 hours where there is a parking restriction, other than a loading restriction.</p> <p>I have been advised that there are a number of off-road parking spaces to the rear of the Chapel and it has a rear entrance. There is also unrestricted parking in the vicinity of some parts of Sovereigns Way and Barrel Arch Close.</p> <p>I hope this information is of assistance however if you wish to discuss the matter further please do not hesitate in contacting me.</p>
		<p>I write with reference to the alteration of the parking restrictions in Marden.</p> <p>I attend the “Gentle Exercise for over 50’s” class at the Marden Congregational Chapel in West End which is held on Thursday mornings from 10:30am. I am 78 and am young compared to others in our class. We have 3 people of 90 which shows the health benefits of exercise.</p>	<p>Thank you for your correspondence received in relation to the above proposed parking restrictions.</p> <p>Your comments have been recorded and will be considered as part of the traffic regulation process.</p> <p>I regret we are unable to reply to each</p>



Comment		<p>Most of us live a fair way from the Chapel and drive and park in the road outside. I have tried parking in the library car park on a fine day but found it full.</p> <p>Our exercise is usually over about 11:15am but we have a cup of tea and chat till about 11:30am and there is another class at 11:45am.</p> <p>The Mother and Toddler group also use the Chapel on 2 other mornings of the week and also park outside on the road as there is nowhere else to park.</p> <p>You will see that the parking ban between 11 – 11:30am would make it very difficult and for some impossible and it would be a shame if these activities were to cease as they enhance village life, cost very little and have a beneficial social aspect.</p> <p>Please reconsider the changes. The existing ban from 9:30 – 10am works well and we are accustomed to it and plan accordingly. The later time would not work for us.</p> <p>I also think that double yellow lines outside the hairdressers and the chippy would lead to a loss of business for these village amenities.</p> <p>-----</p> <p>Thank you for your letter of the 25<sup>th</sup> April regarding the alteration of the parking restrictions in Church Green, Marden.</p> <p>I did not object to the new parking restriction for any business reasons as I have no financial involvement in our exercise class but have objected on the ground that it will put difficulties in the way of a group of OAPs attending an exercise class that we all enjoy and look forward to.</p> <p>The class was formerly held in the Marden Medical Centre until numbers increased and is led by [REDACTED], who is a [REDACTED], with help from her husband. Today 21</p>	<p>individual comment received, however once all replies have been collated a report may be presented to the Joint Transportation Board at their next scheduled meeting with our recommendations, the board will provide their comments on the proposals.</p> <p>Thank you once again for taking the time to record your comments and I look forward to being able to update you on the progress of the proposed parking order in the near future.</p> <p>-----</p> <p>Thank you for your correspondence received in relation to the above Proposed parking restrictions.</p> <p>Maidstone Borough Council have been working closely with the Parish after they conducted extensive consultation within the Parish in an effort manage the parking demand in Marden, discussions then were held with the Parish, Local Councillor's and KCC and it was agreed to formally consult with residents and to put forward the current proposals.</p> <p>During the formal consolation period we received your correspondence raising objection on the grounds that, the new proposal could affect your Business</p> <p>The new proposals are being put forward to provide consistency and designed to have the least inconvenience to residents with the new operational time of 11:00 – 11:30am, Monday – Friday which would allow residents and</p>
---------	--	---	---

		<p>people attended and there were 12 cars parked on the road outside the chapel.</p> <p>As you state there is rear access to the chapel and there was a car park, but it has been taken over by the new houses being built there. There remain probably three spaces: one is needed for the resident of the Manse (who I believe is Disabled), another must go to Sue Smith who needs transport in the event of a medical emergency (after all we are quite elderly) and as the Disabled access to the chapel is from the rear that leaves one space for Disabled if needed. There was also overflow parking at the rear of The Limes but with the new build this has gone completely. Today the builders had parked in the small car park so there were no spaces left.</p> <p>I feel that Marden Parish Council, and yourselves, should do more to support our exercise class as it improves not only our physical wellbeing but offers companionship to a group of people some of whom see little other company during the week.</p> <p>Please help us to continue to enjoy our class without hassle.</p>	<p>visitors to park outside of these times.</p> <p>Disabled drivers who have a Blue Badge can park for 3 hours where there is a parking restriction, other than a loading restriction. I have been advised that there are a number of off-road parking spaces to the rear of the Chapel and it has a rear entrance. There is also unrestricted parking in the vicinity of some parts of Sovereigns Way and Barrel Arch Close.</p> <p>I hope this information is of assistance however if you wish to discuss the matter further please do not hesitate in contacting me.</p>
<p>Objection</p>		<p>I am writing to object to the alteration in lines of parking allowed outside the Congregational Church in Marden.</p> <p>I am very disabled and attend an exercise class there every week and this would mean I could not park. Also, I attend a breathing &amp; singing group on a Thursday afternoon. The exercise class is also on a Thursday morning.</p> <p>Please register my objection.</p> <p>I understand this has to be in by 25<sup>th</sup> March 2019.</p>	<p>Thank you for your correspondence received in relation to the above proposed parking restrictions.</p> <p>Your comments have been recorded and will be considered as part of the traffic regulation process.</p> <p>I regret we are unable to reply to each individual comment received, however once all replies have been collated a report may be presented to the Joint Transportation Board at their next scheduled meeting with our recommendations, the board will provide</p>

			<p>their comments on the proposals. Thank you once again for taking the time to record your comments and I look forward to being able to update you on the progress of the proposed parking order in the near future.</p> <p>-----</p> <p>Further to your letter of objection received in relation to the above Proposed parking restrictions. Maidstone Borough Council have been working closely with the Parish after they conducted extensive consultation within the Parish in an effort manage the parking demand in Marden, discussions then were held with the Parish, Local Councillor's and KCC and it was agreed to formally consult with residents and to put forward the current proposals. During the formal consultation period we received your correspondence raising objection on the grounds that, the new proposal could affect your Business The new proposals are being put forward to provide consistency and designed to have the least inconvenience to residents with the new operational time of 11:00 – 11:30am, Monday – Friday which would allow residents and visitors to park outside of these times. Disabled drivers who have a Blue Badge can park for 3 hours where there is a parking restriction, other than a loading restriction. I have been advised that there are a number</p>
--	--	--	---

			<p>of off-road parking spaces to the rear of the Chapel and it has a rear entrance. There is also unrestricted parking in the vicinity of some parts of Sovereigns Way and Barrel Arch Close.</p> <p>Therefore I respectfully request that you consider withdrawing your objection which would enable us to continue with the proposal and if you are agreeable to withdrawing your objection this must be in writing, or if you wish to discuss the matter further please do not hesitate in contacting me.</p>
--	--	--	--

## PATTENDEN LANE

Objection 8	Comment 7	Support 2
-------------	-----------	-----------

68

Name	Address	Comments	Response
<div> <div></div> <div>Comment</div> </div>	<div> <div></div> </div>	<p>I have been made aware that there are to be double yellow lines put down outside 'Eden Hairdressers'.</p> <p>While I realise it is situated on a very bad corner, there are numerous elderly ladies and gents who need to have access to the door to get into the shop.</p> <p>Parking outside is a problem as some people are just dropped off and are also disabled.</p> <p>Please can you solve the problem that double yellow lines would cause?</p>	<p>Thank you for your correspondence received in relation to the above proposed parking restrictions.</p> <p>Your comments have been recorded and will be considered as part of the traffic regulation process.</p> <p>I regret we are unable to reply to each individual comment received, however once all replies have been collated a report may be presented to the Joint Transportation Board at their next scheduled meeting with our recommendations, the board will provide their comments on the proposals.</p> <p>Thank you once again for taking the time to record your comments and I look forward to being able to update you on the progress of the proposed parking order in the near future.</p> <p>-----</p> <p>Thank you for your correspondence received in relation to the above proposed parking restrictions.</p> <p>Maidstone Borough Council have been working closely with the Parish and after</p>

			<p>discussions with them and Local Councillor's it was agreed to consult with residents and to put forward the current proposals.</p> <p>The new proposals are being put forward to protect the busy junction and allow the free flow of traffic. Under the Highway Code the nearest you can park to a junction is 10 metres (or 32 feet). This is to allow drivers emerging from, or turning into, the junction a clear view of the road they are joining. It also allows them to see hazards such as pedestrians or cyclists at the junction.</p> <p>Disabled drivers who have a Blue Badge can park for 3 hours where there is a parking restriction, other than a loading restriction.</p> <p>There is also unrestricted parking in the vicinity of some parts of Sovereigns Way and Barrel Arch Close.</p> <p>I hope this information is of assistance however if you wish to discuss the matter further please do not hesitate in contacting me.</p>
Support		<p>I am writing to express my support for the proposed changes to street parking in Marden under the above order. I believe these will make the roads safer, particularly the junction at Pattenden Lane.</p>	<p>Thank you for your correspondence received in relation to the above proposed parking restrictions.</p> <p>Your comments have been recorded and will be considered as part of the traffic regulation process.</p> <p>I regret we are unable to reply to each individual comment received, however once all replies have been collated a report may be presented to the Joint Transportation Board at</p>

			<p>their next scheduled meeting with our recommendations, the board will provide their comments on the proposals.</p> <p>Thank you once again for taking the time to record your comments and I look forward to being able to update you on the progress of the proposed parking order in the near future.</p>
Support		<p>I am writing in support of the proposals listed within this order and more specifically those contained within the parish of Marden.</p> <p>Furthermore, the most essential is that regarding Pattenden Lane in terms of both vehicular and pedestrian safety.</p> <p>This junction has been hazardous for many years with cars parking along the northern side of the lane from the railway arch to the very point of entry in West End/Goudhurst Road. The current danger is for several reasons:</p> <ul style="list-style-type: none"> <li>i. The parked cars make it very difficult for drivers turning into Pattenden Lane from West End/Goudhurst Road particularly from the Goudhurst direction where it is almost impossible to see drivers coming along Pattenden Lane who are driving on the wrong side of the road as they have to pass the parked cars.</li> <li>ii. The railway bridge in Pattenden Lane has a severe height restriction. This frequently catches out large trucks needing to access the businesses in Pattenden Lane industrial area. There is therefore often a lot of turning and reversing by these lorries either at the West End/Pattenden Lane junction or at the entrance to Sovereigns Way immediately</li> </ul>	<p>Thank you for your correspondence received in relation to the above proposed parking restrictions.</p> <p>Your comments have been recorded and will be considered as part of the traffic regulation process.</p> <p>I regret we are unable to reply to each individual comment received, however once all replies have been collated a report may be presented to the Joint Transportation Board at their next scheduled meeting with our recommendations, the board will provide their comments on the proposals.</p> <p>Thank you once again for taking the time to record your comments and I look forward to being able to update you on the progress of the proposed parking order in the near future.</p>

		<p>before the bridge. Parked cars only exacerbate these manoeuvres and problems.</p> <p>iii. Pedestrians crossing the top of Pattenden Lane have currently to creep out extremely cautiously before they can ensure they can cross safely. Vehicle drivers likewise also need to be extra vigilant and mindful of the possibility of people appearing in front of them from between parked cars.</p> <p>In addition to all the above it is of course illegal to park at or near a road junction as you will well know. I therefore reiterate my support for this proposal for Marden and hope it can be implemented as soon as possible.</p>	
<p>Objection</p>		<p>I object to the proposed change to parking restrictions outside little Eden. I have used this shop. Since a child I lived in Marden for a long time the only reason to change this to clear it for people to charge round at speed and probable would cause the death of someone. This is a village if you take away this parking it will put our shops out of business. I thought the council wanted to support local businesses? Well. Allow it to stay the same then or we will not have any left you granted loads of houses then want to take away the amenities.</p>	<p>Thank you for your correspondence received in relation to the above proposed parking restrictions.</p> <p>Your comments have been recorded and will be considered as part of the traffic regulation process.</p> <p>I regret we are unable to reply to each individual comment received, however once all replies have been collated a report may be presented to the Joint Transportation Board at their next scheduled meeting with our recommendations, the board will provide their comments on the proposals.</p> <p>Thank you once again for taking the time to record your comments and I look forward to being able to update you on the progress of the proposed parking order in the near future</p> <hr/> <p>Further to your letter of objection in relation</p>



			<p>to the above Proposed parking restrictions. Maidstone Borough Council have been working closely with the Parish after they conducted extensive consultation within the Parish in an effort manage the parking demand in Marden, discussions then were held with the Parish, Local Councillor's and KCC and it was agreed to formally consult with residents and to put forward the current proposals.</p> <p>The new proposals are being put forward to protect the busy junction and allow the free flow of traffic. Under the Highway Code the nearest you can park to a junction is 10 metres (or 32 feet). This is to allow drivers emerging from, or turning into, the junction a clear view of the road they are joining. It also allows them to see hazards such as pedestrians or cyclists at the junction. Disabled drivers who have a Blue Badge can park for 3 hours where there is a parking restriction, other than a loading restriction. There is also unrestricted parking in the vicinity of some parts of Sovereigns Way and Barrel Arch Close.</p> <p>Therefore, I respectfully request that you consider withdrawing your objection which would enable us to continue with the proposal and if you are agreeable to withdrawing your objection this must be in writing, or if you wish to discuss the matter further please do not hesitate in contacting me.</p>
--	--	--	--

<p>Objection</p>	<p>[REDACTED]</p>	<p>I have noticed the parking restrictions posted outside my shop Little Eden Ltd and write to lodge an objection. Whilst I do understand a little further down there is a slight pinch point towards Sovereigns Way there is ample space for three parking spaces outside my shop without interfering with the flow of traffic or any sight lines. In fact, lorries can and do a completed circular turnaround at this junction whilst we are parked there easily without any hindrance. Cars using the junction, tow lorries and vans at the same time pass easily whilst the cars are there, and we never have commuters parking there as there is already a not before 10am restriction. Next door the house has only on road parking, no drive and parks his car at the wider point when he is home. This stops all day parking but allows the eight village businesses on this junction who have been there for twenty-five years to trade as well. This parking outside my shop does not interfere with any junction sight lines. I have customers all day depending on the required service stay from half an hour to 3 hours after ten fits with this ok. To have double yellow lines will seriously cause a dangerous hazard as before ten then there are no cars, cars speed out of this junction hardly braking, seeing cars after ten makes the drivers slow down and be more cautious – natural traffic calming. I am here working from Tuesday to Saturday 8:30am – 5pm and late nights to 10pm. I know more about this junction than anyone, observe this more than anyone. Not only are you proposing changing outside my shop to double yellows but outside the other shops to not between 1:30pm – 2pm. This is the time that people from Pattenden Lane who work there come for a lunchtime haircut or sandwich or chips etc. seriously impacting on our business. I ask that this is reconsidered, and I am allowed at least three</p>	<p>Thank you for your correspondence received in relation to the above proposed parking restrictions. Your comments have been recorded and will be considered as part of the traffic regulation process. I regret we are unable to reply to each individual comment received, however once all replies have been collated a report may be presented to the Joint Transportation Board at their next scheduled meeting with our recommendations, the board will provide their comments on the proposals. Thank you once again for taking the time to record your comments and I look forward to being able to update you on the progress of the proposed parking order in the near future.</p> <hr/> <p>Further to your letter of objection in relation to the above Proposed parking restrictions. Maidstone Borough Council have been working closely with the Parish after they conducted extensive consultation within the Parish in an effort manage the parking demand in Marden, discussions then were held with the Parish, Local Councillor's and KCC and it was agreed to formally consult with residents and to put forward the current proposals. The new proposals are being put forward to protect the busy junction and allow the free flow of traffic. Under the Highway Code the nearest you can park to a junction is 10</p>
------------------	-------------------	---	---

		<p>parking places outside my shop for myself and customer the not between 9:30am – 10am works well here excluding the commuters and allowing us to trade.</p> <p>Already I and my staff have to double handle my car park in a not between 1 – 2pm and moving to after 10am the restrictions around the village this proposal would mean I would not be able to do even this. Where are customers and village workers to park. The station car park is full overflowing and the library car park also full of commuters and the time is early restrictions.</p> <p>On this corner are eight businesses the dentist has parking for four cars and have more staff than that therefore many customers park outside my shop. The Indian has a private car park, but deliveries often park outside my shop. Two road side places outside the butcher one for the Kent Mart and one for the chip shop. It would leave five places for eight businesses we have Marden's only hairdressers, Marden's only dentist, fish and chip shop and butchers here. Although I understand you want to stop commuter parking this is impacting directly on village business and may force them to close if customers cannot use them as they cannot stop here.</p> <p>I request at least three places be left outside my shop and the time not before ten be left as is. Most commuters have gone by then but if villages want social pleasure visits to London bear in mind the library car park is always full during the day only one in ten customers are able to park there. The railway car park is always full too. The parish of Marden is large, and many residents cannot walk to the station, the council has granted extensive building on the basis we are on a railway line then try to prevent commuters parking so completely that they are stopping the village businesses being able to operate. I feel this</p>	<p>metres (or 32 feet). This is to allow drivers emerging from, or turning into, the junction a clear view of the road they are joining. It also allows them to see hazards such as pedestrians or cyclists at the junction.</p> <p>Disabled drivers who have a Blue Badge can park for 3 hours where there is a parking restriction, other than a loading restriction.</p> <p>There is also unrestricted parking in the vicinity of some parts of Sovereigns Way and Barrel Arch Close.</p> <p>Therefore, I respectfully request that you consider withdrawing your objection which would enable us to continue with the proposal and if you are agreeable to withdrawing your objection this must be in writing, or if you wish to discuss the matter further please do not hesitate in contacting me.</p>
--	--	--	--

		would so badly affect my business I may have to close. Unless you can find a viable alternative. I support the yellow lines where there is a pinch point and dropped kerb as this does sometimes cause a little hold up and the tow houses there do have drives for off road parking. Please do not do this I really feel it will put us out of business.	
Objection		<p>My name is [REDACTED] I am in my late 70's and go to the hairdressers in Marden every week. Have done this for 20 years.</p> <p>I cannot walk far; my son waits outside while I have my hair set or permed etc.</p> <p>To put double yellows would prevent me being able to do this.</p> <p>I object, please leave the restriction as not between 9:30 – 10am as is it works fine. I have also seen how it makes the traffic slow down before the junction which is good. Also, it's very wide I see lots of lorries turn around even with cars there so no problems to fix. Only thing this would do is make the junction dangerous.</p>	<p>Thank you for your correspondence received in relation to the above proposed parking restrictions.</p> <p>Your comments have been recorded and will be considered as part of the traffic regulation process.</p> <p>I regret we are unable to reply to each individual comment received, however once all replies have been collated a report may be presented to the Joint Transportation Board at their next scheduled meeting with our recommendations, the board will provide their comments on the proposals.</p> <p>Thank you once again for taking the time to record your comments and I look forward to being able to update you on the progress of the proposed parking order in the near future.</p> <hr/> <p>Further to your letter of objection in relation to the above Proposed parking restrictions. Maidstone Borough Council have been working closely with the Parish after they conducted extensive consultation within the Parish in an effort manage the parking demand in Marden, discussions then were held with the Parish, Local Councillor's and</p>

			<p>KCC and it was agreed to formally consult with residents and to put forward the current proposals.</p> <p>The new proposals are being put forward to protect the busy junction and allow the free flow of traffic. Under the Highway Code the nearest you can park to a junction is 10 metres (or 32 feet). This is to allow drivers emerging from, or turning into, the junction a clear view of the road they are joining. It also allows them to see hazards such as pedestrians or cyclists at the junction.</p> <p>Disabled drivers who have a Blue Badge can park for 3 hours where there is a parking restriction, other than a loading restriction.</p> <p>There is also unrestricted parking in the vicinity of some parts of Sovereigns Way and Barrel Arch Close.</p> <p>Therefore, I respectfully request that you consider withdrawing your objection which would enable us to continue with the proposal and if you are agreeable to withdrawing your objection this must be in writing, or if you wish to discuss the matter further please do not hesitate in contacting me.</p>
Comment		<p>I am writing concerning the new proposed parking restrictions for Church Green, Marden. I understand that the parking of cars to the east side of Pattenden Lane does cause a pinch point at some of the busiest times of the day mainly 16:30 and 17:00 for the end of day traffic from the industrial estate. However, with the width of the road at the junction with Church Green there would be ample</p>	<p>Thank you for your correspondence received in relation to the above proposed parking restrictions.</p> <p>Your comments have been recorded and will be considered as part of the traffic regulation process.</p> <p>I regret we are unable to reply to each</p>

		<p>room for the double yellow lines to start at the road sign between the Old Bank House and 2 Coronation Villas. This would generate perhaps two or three additional absolutely vital spaces to service the collection of shops in that area and still allowing free flow of traffic in either direction at the same time.</p> <p>As for the safety aspect in this location. I have lived in Marden Parish for 61 years and in that time (God forbid it never happens) have not heard of an accident or any injury to a pedestrian reported at this junction.</p> <p>I am personally struggling to find on what grounds the whole scheme has been put forward – safety? There seems to be no evidence for this free flow of traffic? This may hinder a few but does not address the parking of cars at the railway bridge which is the real pinch point. Does 5 seconds delay getting to the junction outweigh the inconvenience and disruption to shops and shoppers this will cause. In regard to the new parking restriction times and extended area all these premises are open during these times with insufficient parking already a problem. This will only compound the pressure they are already under. Where are the business owners and their customers meant to park? I trust that the very least the alterations to create the two parking places will be adopted.</p>	<p>individual comment received, however once all replies have been collated a report may be presented to the Joint Transportation Board at their next scheduled meeting with our recommendations, the board will provide their comments on the proposals.</p> <p>Thank you once again for taking the time to record your comments and I look forward to being able to update you on the progress of the proposed parking order in the near future.</p> <hr/> <p>Thank you for your correspondence received in relation to the above proposed parking restrictions.</p> <p>Maidstone Borough Council have been working closely with the Parish and after discussions with them and Local Councillor's it was agreed to consult with residents and to put forward the current proposals.</p> <p>The new proposals are being put forward to protect the busy junction and allow the free flow of traffic. Under the Highway Code the nearest you can park to a junction is 10 metres (or 32 feet). This is to allow drivers emerging from, or turning into, the junction a clear view of the road they are joining. It also allows them to see hazards such as pedestrians or cyclists at the junction.</p> <p>Disabled drivers who have a Blue Badge can park for 3 hours where there is a parking restriction, other than a loading restriction.</p> <p>There is also unrestricted parking in the vicinity of some parts of Sovereigns Way and</p>
--	--	--	---

			<p>Barrel Arch Close.</p> <p>I hope this information is of assistance however if you wish to discuss the matter further please do not hesitate in contacting me.</p>
<p>Objection</p>		<p>I wish to protest about the above traffic parking changes along Pattenden Lane i.e. double yellow lines all the way up to Church Street. I normally park outside Marden Eden Hair Salon. It is very difficult to park in Marden as the few car parks are always full. It is very wide at the Church Green street end and two lorries can easily pass each other so I do not think the yellow lines need to go all the way to the end of the road. I will need to find another hairdressers if I am unable to park in Marden. I think it will also affect the small business in Marden which is a shame and if this happens it may cause local businesses to close.</p>	<p>Thank you for your correspondence received in relation to the above proposed parking restrictions.</p> <p>Your comments have been recorded and will be considered as part of the traffic regulation process.</p> <p>I regret we are unable to reply to each individual comment received, however once all replies have been collated a report may be presented to the Joint Transportation Board at their next scheduled meeting with our recommendations, the board will provide their comments on the proposals.</p> <p>Thank you once again for taking the time to record your comments and I look forward to being able to update you on the progress of the proposed parking order in the near future.</p> <hr/> <p>Further to your letter of objection in relation to the above Proposed parking restrictions. Maidstone Borough Council have been working closely with the Parish after they conducted extensive consultation within the Parish in an effort manage the parking demand in Marden, discussions then were held with the Parish, Local Councillor's and</p>

			<p>KCC and it was agreed to formally consult with residents and to put forward the current proposals.</p> <p>The new proposals are being put forward to protect the busy junction and allow the free flow of traffic. Under the Highway Code the nearest you can park to a junction is 10 metres (or 32 feet). This is to allow drivers emerging from, or turning into, the junction a clear view of the road they are joining. It also allows them to see hazards such as pedestrians or cyclists at the junction.</p> <p>Disabled drivers who have a Blue Badge can park for 3 hours where there is a parking restriction, other than a loading restriction.</p> <p>There is also unrestricted parking in the vicinity of some parts of Sovereigns Way and Barrel Arch Close.</p> <p>Therefore, I respectfully request that you consider withdrawing your objection which would enable us to continue with the proposal and if you are agreeable to withdrawing your objection this must be in writing, or if you wish to discuss the matter further please do not hesitate in contacting me.</p>
<p>Objection</p>		<p>I am obliged to write to let you know that I object and am very unhappy about the proposal of placing double yellow lines outside a hairdresser that I have used for many years. This is a small business that provides a great service to the local community and surrounding area. By imposing parking restrictions such as double yellow lines outside of the premises will prevent me, and many others, from</p>	<p>Thank you for your correspondence received in relation to the above proposed parking restrictions.</p> <p>Your comments have been recorded and will be considered as part of the traffic regulation process.</p> <p>I regret we are unable to reply to each</p>



		<p>attending and as such will be a direct cause of the business failing and ultimately having to close.</p> <p>I work in Medway and visit the salon on an evening after work. I also pass through Marden on a regular basis and have never found that the few (very few) parked cars outside the salon make any impact on my ability to view the road ahead, in fact I would argue that I almost view the parked cars as a traffic calming element.</p> <p>I am aware that the hairdresser, Elaine, travels to Yalding to collect older customers of hers that previously used the salon in Yalding. She does this, not simply because she needs the business, because without her they cannot access a hairdresser locally. They have mobility issues and by her collecting them in her car and being able to park outside her shop they are able to have their hair done, have a good catch up and often finish off with some chips from the chippy across the road. She adds a great deal to the lives of these older people, who rarely get out and spend far too many hours alone.</p> <p>The idea that parking restrictions such as double yellow lines will prevent accidents or impact on commuters is quite frankly ludicrous. It is not an "accident hotspot".</p>	<p>individual comment received, however once all replies have been collated a report may be presented to the Joint Transportation Board at their next scheduled meeting with our recommendations, the board will provide their comments on the proposals.</p> <p>Thank you once again for taking the time to record your comments and I look forward to being able to update you on the progress of the proposed parking order in the near future.</p> <hr/> <p>Further to your letter of objection in relation to the above Proposed parking restrictions. Maidstone Borough Council have been working closely with the Parish after they conducted extensive consultation within the Parish in an effort manage the parking demand in Marden, discussions then were held with the Parish, Local Councillor's and KCC and it was agreed to formally consult with residents and to put forward the current proposals.</p> <p>The new proposals are being put forward to protect the busy junction and allow the free flow of traffic. Under the Highway Code the nearest you can park to a junction is 10 metres (or 32 feet). This is to allow drivers emerging from, or turning into, the junction a clear view of the road they are joining. It also allows them to see hazards such as pedestrians or cyclists at the junction.</p> <p>Disabled drivers who have a Blue Badge can park for 3 hours where there is a parking</p>
--	--	--	---

			<p>restriction, other than a loading restriction. There is also unrestricted parking in the vicinity of some parts of Sovereigns Way and Barrel Arch Close.</p> <p>Therefore, I respectfully request that you consider withdrawing your objection which would enable us to continue with the proposal and if you are agreeable to withdrawing your objection this must be in writing, or if you wish to discuss the matter further please do not hesitate in contacting me.</p>
<p>Comment</p>		<p>I understand that Maidstone Borough Council are planning to install double yellow lines from West End Church Green to Coronation Villas.</p> <p>I visit the hairdressers once a week and other businesses during the week. Where will I be able to park?</p> <p>I have lived in Marden all my life and as far as I know there has never been an accident, so why is this happening after all these years?</p>	<p>Thank you for your correspondence received in relation to the above proposed parking restrictions.</p> <p>Your comments have been recorded and will be considered as part of the traffic regulation process.</p> <p>I regret we are unable to reply to each individual comment received, however once all replies have been collated a report may be presented to the Joint Transportation Board at their next scheduled meeting with our recommendations, the board will provide their comments on the proposals.</p> <p>Thank you once again for taking the time to record your comments and I look forward to being able to update you on the progress of the proposed parking order in the near future.</p> <hr/> <p>Thank you for your correspondence received in relation to the above proposed parking restrictions.</p>

			<p>Maidstone Borough Council have been working closely with the Parish and after discussions with them and Local Councillor's it was agreed to consult with residents and to put forward the current proposals.</p> <p>The new proposals are being put forward to protect the busy junction and allow the free flow of traffic. Under the Highway Code the nearest you can park to a junction is 10 metres (or 32 feet). This is to allow drivers emerging from, or turning into, the junction a clear view of the road they are joining. It also allows them to see hazards such as pedestrians or cyclists at the junction.</p> <p>Disabled drivers who have a Blue Badge can park for 3 hours where there is a parking restriction, other than a loading restriction.</p> <p>There is also unrestricted parking in the vicinity of some parts of Sovereigns Way and Barrel Arch Close.</p> <p>I hope this information is of assistance however if you wish to discuss the matter further please do not hesitate in contacting me.</p>
Objection		<p>I understand that it is the intention to create the area to the top of Pattenden Lane by the line of shops to double yellow lines from the junction at Church Green to Sovereigns Way, Marden.</p> <p>I am writing to strongly oppose this. I have lived in Marden for over 40 years. I have watched the increase in house numbers and the decline of shops in our village.</p> <p>If the area is completely clear by the double yellow lines,</p>	<p>Thank you for your correspondence received in relation to the above proposed parking restrictions.</p> <p>Your comments have been recorded and will be considered as part of the traffic regulation process.</p> <p>I regret we are unable to reply to each individual comment received, however once</p>

		<p>this will not only give the shops the kiss of death but will then increase the speeds of the ever-increasing number of drivers through the village, with the potential of someone getting hurt on the newly installed pedestrian crossing slightly further up. Whilst at present, this area is a bit of a pinch point, this does naturally act as traffic calmi9ng during rush hour periods and to my knowledge in all this time I have been here no one to date has been hurt (if it's not broken, don't fix it).</p> <p>I urge you to reconsider and help our ailing shops and village community to survive.</p>	<p>all replies have been collated a report may be presented to the Joint Transportation Board at their next scheduled meeting with our recommendations, the board will provide their comments on the proposals.</p> <p>Thank you once again for taking the time to record your comments and I look forward to being able to update you on the progress of the proposed parking order in the near future.</p> <hr/> <p>Further to your letter of objection in relation to the above Proposed parking restrictions. Maidstone Borough Council have been working closely with the Parish after they conducted extensive consultation within the Parish in an effort manage the parking demand in Marden, discussions then were held with the Parish, Local Councillor's and KCC and it was agreed to formally consult with residents and to put forward the current proposals.</p> <p>The new proposals are being put forward to protect the busy junction and allow the free flow of traffic. Under the Highway Code the nearest you can park to a junction is 10 metres (or 32 feet). This is to allow drivers emerging from, or turning into, the junction a clear view of the road they are joining. It also allows them to see hazards such as pedestrians or cyclists at the junction. Disabled drivers who have a Blue Badge can park for 3 hours where there is a parking restriction, other than a loading restriction.</p>
--	--	---	---

			<p>There is also unrestricted parking in the vicinity of some parts of Sovereigns Way and Barrel Arch Close.</p> <p>Therefore, I respectfully request that you consider withdrawing your objection which would enable us to continue with the proposal and if you are agreeable to withdrawing your objection this must be in writing, or if you wish to discuss the matter further please do not hesitate in contacting me.</p>
<p>Objection</p>		<p>I understand that it is the council's intention to change the area to the top of Pattenden Lane by the line of shops to double yellow lines from the junction at Church Green to Sovereigns Way, Marden.</p> <p>I am writing to strongly oppose this.</p> <p>We have seen the decline of shops in our village over the last few years. There are no parking facilities close to the last few remaining shops at the junction so to change the parking lines to double yellows will be the final nail.</p> <p>Cars parking in the vicinity whilst using the shops only act to slow the ever-increasing amount of traffic down through this area and to my knowledge in all the time, I have been here no one to date has been hurt.</p> <p>I urge you to reconsider and help our ailing shops and village community to survive.</p>	<p>Thank you for your correspondence received in relation to the above proposed parking restrictions.</p> <p>Your comments have been recorded and will be considered as part of the traffic regulation process.</p> <p>I regret we are unable to reply to each individual comment received, however once all replies have been collated a report may be presented to the Joint Transportation Board at their next scheduled meeting with our recommendations, the board will provide their comments on the proposals.</p> <p>Thank you once again for taking the time to record your comments and I look forward to being able to update you on the progress of the proposed parking order in the near future.</p> <hr/> <p>Further to your letter of objection in relation to the above Proposed parking restrictions. Maidstone Borough Council have been working closely with the Parish after they</p>

			<p>conducted extensive consultation within the Parish in an effort manage the parking demand in Marden, discussions then were held with the Parish, Local Councillor's and KCC and it was agreed to formally consult with residents and to put forward the current proposals.</p> <p>The new proposals are being put forward to protect the busy junction and allow the free flow of traffic. Under the Highway Code the nearest you can park to a junction is 10 metres (or 32 feet). This is to allow drivers emerging from, or turning into, the junction a clear view of the road they are joining. It also allows them to see hazards such as pedestrians or cyclists at the junction. Disabled drivers who have a Blue Badge can park for 3 hours where there is a parking restriction, other than a loading restriction. There is also unrestricted parking in the vicinity of some parts of Sovereigns Way and Barrel Arch Close.</p> <p>Therefore, I respectfully request that you consider withdrawing your objection which would enable us to continue with the proposal and if you are agreeable to withdrawing your objection this must be in writing, or if you wish to discuss the matter further please do not hesitate in contacting me.</p>
		<p>I write with reference to the proposed revised parking arrangements at the junction of Pattenden Lane, Marden. These ARE currently No Parking between 09:30 and</p>	<p>Thank you for your correspondence received in relation to the above proposed parking restrictions.</p>

Objection		<p>10:00am, but the intention apparently is to make this an all-day restriction with double yellow lines.</p> <p>This will adversely affect the small businesses in that area and most specifically that of Little Eden hairdressing salon whose clientele require at least a couple of hours for parking because of the nature of the business. And from a personal point of view, as I do not drive and a pensioner, I have visited the Salon regularly over the last 25 years and if it is forced to close because of this proposed new restriction I will have to go further afield and public transport does not allow any flexibility for this which will cause extreme inconvenience.</p> <p>Apparently, Marden Parish Council are treating this as a laughing matter and have no interest in what might be the forced closure of [REDACTED]</p> <p>I thought the Government policy was to encourage small businesses not discourage them!</p> <p>Therefore, in view of the above I STRONGLY OBJECT to the proposed new restrictions on parking.</p>	<p>Your comments have been recorded and will be considered as part of the traffic regulation process.</p> <p>I regret we are unable to reply to each individual comment received, however once all replies have been collated a report may be presented to the Joint Transportation Board at their next scheduled meeting with our recommendations, the board will provide their comments on the proposals.</p> <p>Thank you once again for taking the time to record your comments and I look forward to being able to update you on the progress of the proposed parking order in the near future.</p> <hr/> <p>Further to your letter of objection in relation to the above Proposed parking restrictions. Maidstone Borough Council have been working closely with the Parish after they conducted extensive consultation within the Parish in an effort manage the parking demand in Marden, discussions then were held with the Parish, Local Councillor's and KCC and it was agreed to formally consult with residents and to put forward the current proposals.</p> <p>The new proposals are being put forward to protect the busy junction and allow the free flow of traffic. Under the Highway Code the nearest you can park to a junction is 10 metres (or 32 feet). This is to allow drivers emerging from, or turning into, the junction a clear view of the road they are joining. It also</p>
-----------	--	---	---

			<p>allows them to see hazards such as pedestrians or cyclists at the junction. Disabled drivers who have a Blue Badge can park for 3 hours where there is a parking restriction, other than a loading restriction. There is also unrestricted parking in the vicinity of some parts of Sovereigns Way and Barrel Arch Close.</p> <p>Therefore, I respectfully request that you consider withdrawing your objection which would enable us to continue with the proposal and if you are agreeable to withdrawing your objection this must be in writing, or if you wish to discuss the matter further please do not hesitate in contacting me.</p>
Comment		<p>With regard to the above order I would like to comment as follows:</p> <ol style="list-style-type: none"> <li>1. The current restriction on parking should remain the same.</li> <li>2. The traffic calming effect of the current system is of benefit in preventing the junction becoming a natural accident spot.</li> <li>3. The effect on the established businesses will probably cause the eventual closure of a retail outlet which will not be of benefit to Marden as a whole.</li> <li>4. Although parking is always an issue in a village like Marden, I think that a more imaginative solution could be sought by further consultation with those involved and its impact on the local plan.</li> </ol>	<p>Thank you for your correspondence received in relation to the above proposed parking restrictions.</p> <p>Your comments have been recorded and will be considered as part of the traffic regulation process.</p> <p>I regret we are unable to reply to each individual comment received, however once all replies have been collated a report may be presented to the Joint Transportation Board at their next scheduled meeting with our recommendations, the board will provide their comments on the proposals.</p> <p>Thank you once again for taking the time to record your comments and I look forward to being able to update you on the progress of the proposed parking order in the near future.</p>



			<p>Thank you for your correspondence received in relation to the above proposed parking restrictions.</p> <p>Maidstone Borough Council have been working closely with the Parish and after discussions with them and Local Councillor's it was agreed to consult with residents and to put forward the current proposals.</p> <p>The new proposals are being put forward to protect the busy junction and allow the free flow of traffic. Under the Highway Code the nearest you can park to a junction is 10 metres (or 32 feet). This is to allow drivers emerging from, or turning into, the junction a clear view of the road they are joining. It also allows them to see hazards such as pedestrians or cyclists at the junction.</p> <p>Disabled drivers who have a Blue Badge can park for 3 hours where there is a parking restriction, other than a loading restriction.</p> <p>There is also unrestricted parking in the vicinity of some parts of Sovereigns Way and Barrel Arch Close.</p> <p>I hope this information is of assistance however if you wish to discuss the matter further please do not hesitate in contacting me.</p>
		<p>I called in to see you last week to discuss this change to parking restrictions at the end of Pattenden Lane, but you were out. Lou very helpfully gave me the Notice of the Order to respond to and also advised me that this had</p>	<p>Thank you for your correspondence received in relation to the above proposed parking restrictions.</p> <p>Your comments have been recorded and will</p>

Comment		<p>been initiated by the Parish Council.</p> <p>Whilst I can see the need to install double yellow lines where the road narrows outside the cottages, I really don't think it is necessary to extend this in front of the shops, where parking is currently allowed after 10:00am and the road gets wider towards the junction with Church Green. This is likely to have a detrimental effect on their trading which currently relies heavily on short stay parking outside these stores.</p> <p>Can I request, therefore, that the present parking restrictions are maintained from outside the Eden Hairdressers and along the length of this small parade of shops. I hope you will agree with me on this.</p> <hr/> <p>Thank you for taking the trouble to reply to my comments with regard to this consultation.</p> <p>I can understand the reasons for imposing a 10 metre restriction on parking near a junction where such a junction is at right angles to the main road. However, in the case of Pattenden Lane, this junction has a wide splay on the left hand side that facilitates visibility in both directions when exiting Pattenden Lane. I maintain therefore that there is still ample space to allow some time limited parking at this point.</p> <p>I am aware that the Parish Council has initiated this consultation but surely the purpose of having a consultation is to solicit responses and not simply to endorse the Parish Council's view.</p> <p>As I said before, I believe removing this parking area will be harmful to the local traders and I hope you will take this into consideration in determining the outcome on this.</p>	<p>be considered as part of the traffic regulation process.</p> <p>I regret we are unable to reply to each individual comment received, however once all replies have been collated a report may be presented to the Joint Transportation Board at their next scheduled meeting with our recommendations, the board will provide their comments on the proposals.</p> <p>Thank you once again for taking the time to record your comments and I look forward to being able to update you on the progress of the proposed parking order in the near future.</p> <hr/> <p>Thank you for your correspondence received in relation to the above proposed parking restrictions.</p> <p>Maidstone Borough Council have been working closely with the Parish and after discussions with them and Local Councillor's it was agreed to consult with residents and to put forward the current proposals.</p> <p>The new proposals are being put forward to protect the busy junction and allow the free flow of traffic. Under the Highway Code the nearest you can park to a junction is 10 metres (or 32 feet). This is to allow drivers emerging from, or turning into, the junction a clear view of the road they are joining. It also allows them to see hazards such as pedestrians or cyclists at the junction.</p> <p>Disabled drivers who have a Blue Badge can park for 3 hours where there is a parking</p>
---------	--	--	--

			<p>restriction, other than a loading restriction. There is also unrestricted parking in the vicinity of some parts of Sovereigns Way and Barrel Arch Close.</p> <p>I hope this information is of assistance however if you wish to discuss the matter further please do not hesitate in contacting me.</p> <hr/> <p>Thank you for your further correspondence received in relation to the above proposed parking restrictions.</p> <p>Unfortunately the proposals are still being discussed. As soon as a decision has been reached, I will inform you.</p>
Comment		<p>I am writing regarding the proposal to put double yellow lines on the end of Pattenden Lane meeting the High Street, Marden.</p> <p>I regularly attend Little Eden Hairdressers and the shops. To have no parking outside the hairdressers would make it very difficult to attend appointments at Little Eden. I do not live in the village and need to bring my car to the village. There is very little available car parking in the village.</p> <p>I also think it would be disadvantageous to change the limited time to lunch time as this is the times many people will access the shops and hairdressers in their lunch time. I would be very grateful if you could reconsider these proposals.</p>	<p>Thank you for your correspondence received in relation to the above proposed parking restrictions.</p> <p>Your comments have been recorded and will be considered as part of the traffic regulation process.</p> <p>I regret we are unable to reply to each individual comment received, however once all replies have been collated a report may be presented to the Joint Transportation Board at their next scheduled meeting with our recommendations, the board will provide their comments on the proposals.</p> <p>Thank you once again for taking the time to record your comments and I look forward to being able to update you on the progress of</p>

			<p>the proposed parking order in the near future.</p> <p>Thank you for your correspondence received in relation to the above proposed parking restrictions.</p> <p>Maidstone Borough Council have been working closely with the Parish and after discussions with them and Local Councillor's it was agreed to consult with residents and to put forward the current proposals.</p> <p>The new proposals are being put forward to protect the busy junction and allow the free flow of traffic. Under the Highway Code the nearest you can park to a junction is 10 metres (or 32 feet). This is to allow drivers emerging from, or turning into, the junction a clear view of the road they are joining. It also allows them to see hazards such as pedestrians or cyclists at the junction.</p> <p>Disabled drivers who have a Blue Badge can park for 3 hours where there is a parking restriction, other than a loading restriction.</p> <p>There is also unrestricted parking in the vicinity of some parts of Sovereigns Way and Barrel Arch Close.</p> <p>I hope this information is of assistance however if you wish to discuss the matter further please do not hesitate in contacting me.</p>
		<p>I am in my 80's and would urge you to reconsider putting double yellow lines outside the only hairdresser in Marden – is it your intention to put them out of business and thus</p>	<p>Thank you for your correspondence received in relation to the above proposed parking restrictions.</p>

Comment		lose a lot of people making use of village facilities? Not everyone drives and parking spaces for those who do, are very sparse. Would it be possible to have one or two spaces at the hairdresser for clients? Please reconsider.	<p>Your comments have been recorded and will be considered as part of the traffic regulation process.</p> <p>I regret we are unable to reply to each individual comment received, however once all replies have been collated a report may be presented to the Joint Transportation Board at their next scheduled meeting with our recommendations, the board will provide their comments on the proposals.</p> <p>Thank you once again for taking the time to record your comments and I look forward to being able to update you on the progress of the proposed parking order in the near future.</p> <hr/> <p>Thank you for your correspondence received in relation to the above proposed parking restrictions.</p> <p>Maidstone Borough Council have been working closely with the Parish and after discussions with them and Local Councillor's it was agreed to consult with residents and to put forward the current proposals.</p> <p>The new proposals are being put forward to protect the busy junction and allow the free flow of traffic. Under the Highway Code the nearest you can park to a junction is 10 metres (or 32 feet). This is to allow drivers emerging from, or turning into, the junction a clear view of the road they are joining. It also allows them to see hazards such as pedestrians or cyclists at the junction.</p> <p>Disabled drivers who have a Blue Badge can</p>
---------	---	--	--

			<p>park for 3 hours where there is a parking restriction, other than a loading restriction. There is also unrestricted parking in the vicinity of some parts of Sovereigns Way and Barrel Arch Close.</p> <p>I hope this information is of assistance however if you wish to discuss the matter further please do not hesitate in contacting me.</p>
--	--	--	--

## MARDEN - GENERAL

Objection 2	Comment	Support 1
-------------	---------	-----------

Name	Address	Comments	Response
Support		Just to confirm that Marden Parish Council supports the amendments to the change of restriction times and the new proposals of double yellow lines in the village.	<p>Thank you for your correspondence received in relation to the above proposed parking restrictions.</p> <p>Your support has been recorded and will be considered as part of the traffic regulation process.</p> <p>I regret we are unable to reply to each individual comment received, however once all replies have been collated a report may be presented to the Joint Transportation Board at their next scheduled meeting with our recommendations, the board will provide their comments on the proposals.</p> <p>Thank you once again for taking the time to record your comments and I look forward to being able to update you on the progress of the proposed parking order in the near future.</p>
Objection		<p>I wish to object to the above variation because I think it will directly harm local businesses who rely on customers being able to park nearby and conveniently. This is particularly so in relation to the elderly.</p> <p>It is very dangerous in the present economic climate to hurt local businesses who are struggling to compete with</p>	<p>Thank you for your correspondence received in relation to the above proposed parking restrictions.</p> <p>Your comments have been recorded and will be considered as part of the traffic regulation process.</p>

	<p>town centres but above all with online shopping. The whole point about local villages is that they are nearby and convenient to pop out to buy limited amounts of goods and services without a huge fuss. With all due respect Maidstone Town Centre is something of a nightmare to go to because of the parking. I will do all I can to shop locally rather than to visit the town centre. Now you are making that difficult.</p> <p>Sometimes it is difficult to park in the Marden public car parks which are crowded in modern village. It is also difficult for employees forced to move their cars at different times. As I understand the proposals, you are going to make it difficult to simply park nearby local shops at certain times.</p> <p>You should make parking easier not more difficult. Attention has also been drawn to the particular problems of elderly people for example, unable to walk long distance is without difficulties. For example, those who wish to have a longer appointment at the hairdressers will be hit hard by these restrictions.</p> <p>If you restrict parking dramatically in the late morning that may well act as a deterrent for people wishing to go to the local shops simply to pick something up at the last minute. They may have difficulty remembering the times of the restrictions and may not bother. So it is bad for shops. It is bad for customers.</p> <p>I also wish to ask at the junction concerned how many accidents have there been because I am not aware of any. Is this a money revenue raising matter rather than a serious problem that needs to be addressed. There is a pedestrian crossing which works perfectly well. There is no need for pedestrians to fear short-term parking and many of these pedestrians will have arrived in their vehicles to</p>	<p>I regret we are unable to reply to each individual comment received, however once all replies have been collated a report may be presented to the Joint Transportation Board at their next scheduled meeting with our recommendations, the board will provide their comments on the proposals.</p> <p>Thank you once again for taking the time to record your comments and I look forward to being able to update you on the progress of the proposed parking order in the near future.</p> <hr/> <p>Further to your letter of objection in relation to the above Proposed parking restrictions. Maidstone Borough Council have been working closely with the Parish after they conducted extensive consultation within the Parish in an effort manage the parking demand in Marden, discussions then were held with the Parish, Local Councillor's and KCC and it was agreed to formally consult with residents and to put forward the current proposals.</p> <p>The new proposals are being put forward to provide consistency and designed to have the least inconvenience to residents. Disabled drivers who have a Blue Badge can park for 3 hours where there is a parking restriction, other than a loading restriction. There is also unrestricted parking in the vicinity of some parts of Sovereigns Way and Barrel Arch Close.</p> <p>Therefore, I respectfully request that you</p>
--	--	--



		<p>attend local shops in any event.</p> <p>As a long-term resident in the area I have never had major difficulties with site lines and feel the council is attempting to address a problem which does not exist and may in fact cause more problems for local residents and businesses.</p>	<p>consider withdrawing your objection which would enable us to continue with the proposal and if you are agreeable to withdrawing your objection this must be in writing, or if you wish to discuss the matter further please do not hesitate in contacting me.</p>
Objection		<p>I am writing to raise my opposition to the above proposals. I live in Bramley Court retirement complex and I rely heavily on using local shops and services as I do not drive and cannot walk to the top of the village without difficulty. I use the hairdressers at the top of Pattenden Lane, as well as the butchers, take away and restaurant. I also use the shop in particular to draw money out. Anything that affects the visibility of these businesses affects me personally, and I am sure a lot of the other residents in Bramley Court. My hairdresser tells me that she struggles as it is to find somewhere to park as the spaces already there are mostly used by people who live upstairs in the other premises, and that a lot of her clients come by car and they would be put off by the lack of parking. This is a business that has been in Marden for over 20 years and is the only hairdresser.</p> <p>I also do not agree that making it too easy to spin around the corner from Goudhurst Road is a good thing or even desirable. There is no safe place to cross on this corner, and it is particularly dangerous at night. There needs to be a way to slow this traffic down, not speed it up. At least with parked cars it is possible to step out part of the way with some protection and where visibility is better. There needs to be a pedestrian crossing here somewhere.</p> <p>I also know that a lot of the residents here, myself included, rely on the West End Tavern for evenings out and</p>	<p>Thank you for your correspondence received in relation to the above proposed parking restrictions.</p> <p>Your comments have been recorded and will be considered as part of the traffic regulation process.</p> <p>I regret we are unable to reply to each individual comment received, however once all replies have been collated a report may be presented to the Joint Transportation Board at their next scheduled meeting with our recommendations, the board will provide their comments on the proposals.</p> <p>Thank you once again for taking the time to record your comments and I look forward to being able to update you on the progress of the proposed parking order in the near future.</p> <hr/> <p>Further to your letter of objection in relation to the above Proposed parking restrictions. Maidstone Borough Council have been working closely with the Parish after they conducted extensive consultation within the Parish in an effort to manage the parking demand in Marden, discussions then were held with the Parish, Local Councillor's and</p>

		<p>for Sunday roasts, etc. Anything that harms their business affects me, and heaven forbid that we lose another pub because of a badly thought out council decision. In my view, if parking restrictions are not needed during the rush hour, they are not needed at all. What is the benefit of a parking restriction from 11:00 to 11:30am and who will benefit? Certainly not the pub, which opens for breakfasts and business before 11:00am. I disagree with anything that puts the West End Tavern at risk.</p> <p>It seems to me that the lower end of the village is treated less favourably than the top end, which already has parking by the library. I do not believe it is fair to remove parking spaces here without providing an alternative. There is obviously a need for more parking spaces here, not less. I do hope that my objections will be taken into account.</p> <p>-----</p> <p>I write further to your letter to me dated 25 April 2019 requesting that I remove my objection to the proposed parking restrictions</p> <p>I am afraid that I cannot do so The draft Parish Local Plan specifically mentions the importance of the small business area at the top of Pattenden Lane and that they would continue to support it I am afraid that removing parking from outside the business premises there would be the death knell for some, if not all of them There must be a way to make this road crossing safer</p> <p><u>I am surprised that Highways have not asked the house on the corner of Pattenden Lane and Goudhurst Road to cut down their tall hedge all around the corner, which is a danger to both vehicles and pedestrians by creating a large blind spot</u></p> <p>I am sure that by providing a few zoned parking spaces for the business and perhaps changing the pavement</p>	<p>KCC and it was agreed to formally consult with residents and to put forward the current proposals.</p> <p>The new proposals are being put forward to provide consistency and designed to have the least inconvenience to residents.</p> <p>Disabled drivers who have a Blue Badge can park for 3 hours where there is a parking restriction, other than a loading restriction.</p> <p>There is also unrestricted parking in the vicinity of some parts of Sovereigns Way and Barrel Arch Close.</p> <p>Therefore, I respectfully request that you consider withdrawing your objection which would enable us to continue with the proposal and if you are agreeable to withdrawing your objection this must be in writing, or if you wish to discuss the matter further please do not hesitate in contacting me.</p>
--	--	---	--

		<p>boundaries it would be possible to put a refuge in the middle of the road for pedestrians</p> <p>I am sure Kent Highways have faced more difficult problems than this Hindering sensitive local businesses should be a last resort, and I do not feel that this is the case here</p>	
--	--	---	--

## HUNTSMAN LANE

Objection	Comment	Support 1
-----------	---------	-----------

Name	Address	Comments	Response
Support		<p>I am writing in response to the notification placed in Huntsman Lane outside of Invicta Grammar School, advising Maidstone Borough Councils proposal to extend the single yellow line parking restrictions already in operation from 10:30am – 11:00am, Monday to Friday, to 08:00am – 6:30pm, Monday to Saturday.</p> <p>Not only as a school, but as a trust (Valley Invicta Academies Trust) we fully support and commend the amendment you propose. For many years we have had serious concerns based around traffic movements along Huntsman Lane and feel this is a significant step in improving the situation. As a result of parked cars along the length of road you are proposing, the bus stops immediately opposite are seriously compromised. Both in the morning during the drop off period and the afternoon collection window, traffic is unable to move, let alone flow due to the parked cars leaving no thoroughfare for traffic. I am aware that traffic issues are common place around the vicinity of many schools. However, we have a scenario of two secondary schools on one campus plus a further primary school, all accessed from the one minor road which struggles to cope with the volume of traffic created. As I have previously commented, we are in favour of the traffic order you propose, however feel that this is just the</p>	<p>Thank you for your correspondence received in relation to the above proposed parking restrictions.</p> <p>Your support has been recorded and will be considered as part of the traffic regulation process.</p> <p>I regret we are unable to reply to each individual comment received, however once all replies have been collated a report may be presented to the Joint Transportation Board at their next scheduled meeting with our recommendations, the board will provide their comments on the proposals.</p> <p>Thank you once again for taking the time to record your comments and I look forward to being able to update you on the progress of the proposed parking order in the near future. Unfortunately, the implementation of one-way traffic systems are not within Maidstone Borough Council's remit; however this would be the responsibility of Kent County Council Highway Services.</p> <p>Please find the link below which outlines the process for application.</p>

		<p>first step to necessary improvements. We feel that a further improvement would be to make Hunstman Lane a one-way road in the northerly direction. This would greatly improve the dangerous situation outside of the school's entrance.</p> <p>I appreciate this is probably not your area of concern but would in turn greatly appreciate your thoughts on this matter and if possible, the contact details of your colleagues who would ne able to discuss this possibility with myself.</p> <p>I await your thought on this matter and thank you in anticipation.</p>	<p><a href="http://www.kent.gov.uk/roads-and-travel/what-we-look-after/roads/changing-roads-in-your-area">http://www.kent.gov.uk/roads-and-travel/what-we-look-after/roads/changing-roads-in-your-area</a></p> <p>Alternatively, you may wish to make contact with Kent County Council on either tel. 03000 41 41 41 or <a href="http://www.kent.gov.uk">www.kent.gov.uk</a> to make your report/request and receive a case number. This will enable you to track and monitor the progress of any request made.</p>
--	--	---	---

## Appendix C



Amend waiting restrictions in Pattenden Lane, Church Green to Medway Cottages from 09.30 am - 10.00 am to 1.30-2.00pm (east side from 2 Coronations Villas to Medway Cottages).

Implement No waiting at any time DYL restrictions on the East side, from junction of Church Green to boundary of 2 Coronation Villas

Implement No waiting at any time DYL restrictions on DYL West side, from its junction with West End to Sovereigns Way

The map shows a residential area with several buildings labeled: 'Coronation Villa', 'Little Eden', 'Garage', 'Jubilee House', 'South Lodge', and 'Stat'. A road labeled 'CHURCH GREEN' runs diagonally across the bottom right. A yellow line indicates a waiting restriction area. A table below the map lists the details of this restriction.

Type of waiting restriction	Schedule	Schedule description	Hours of operation	Item no	Road	Side of road	Description	Prescribed hours	Restricted hours	Order year	Author
Waiting Restrictions	1	-	Between 9.30am to 10.00am Monday to Friday inclusive	82a	Church Green (B2079), MARDEN	Both	From a point 10 metres west of its junction with Chantry Road to its junction with Pattenden Lane	J	-	2008	Maidst

Amend waiting restrictions in Church Green, Pattenden Lane to Station Approach both sides from 09.30 -10.00 am to 1.30-2.00pm.

Church Green, north side from junction of Pattenden Lane to Station Approach and south side from opposite Pattenden Lane to junction with Chantry Road from 9.30 -10.00 to 1.30 -2.00pm

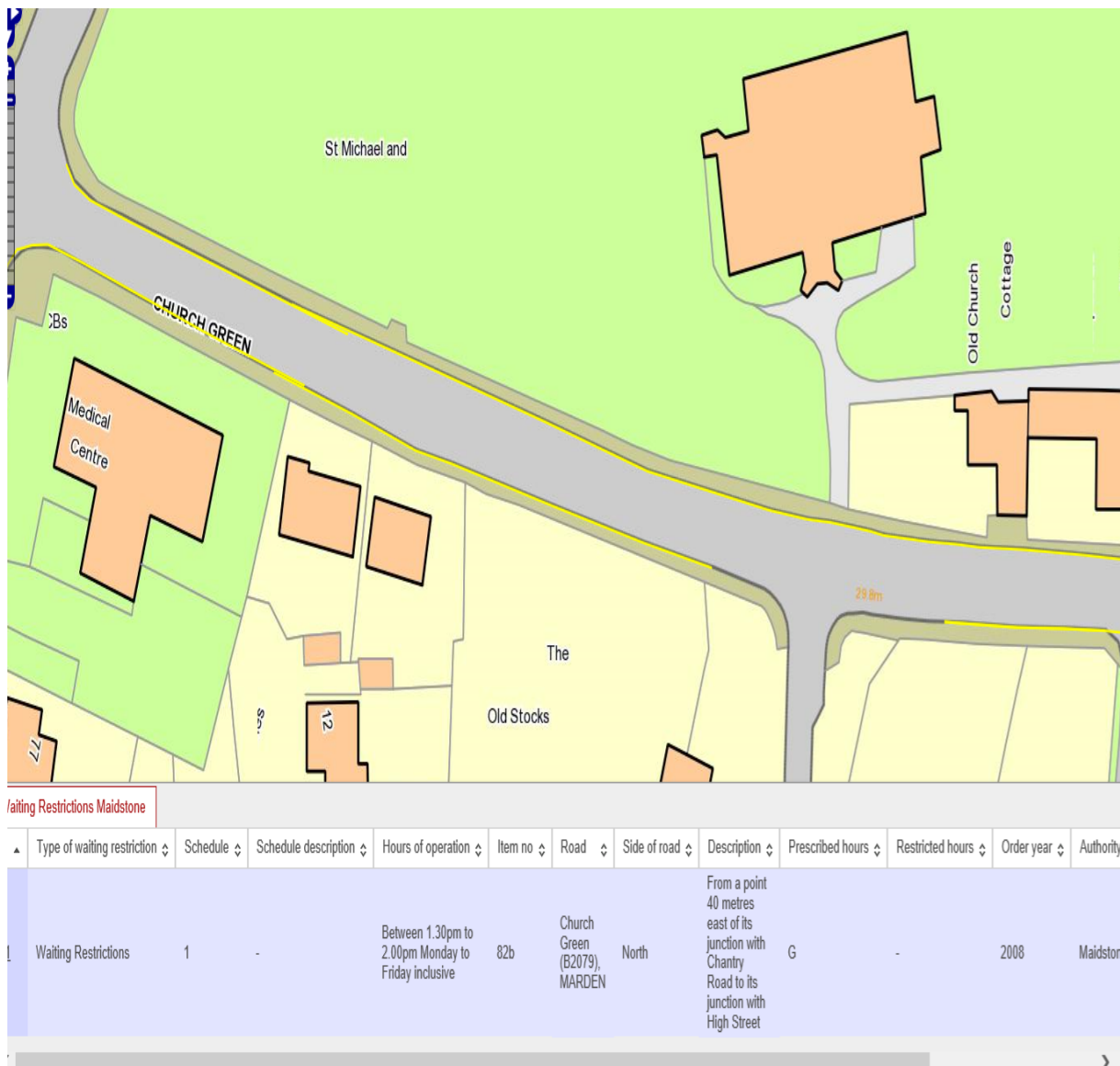

Amend waiting restrictions in Church Green/High Street, from Doctors Surgery to Old Market, both sides from 10.30 am -11.00am to 1.30-2.00pm.

Church Green north side from junction with Station Approach to junction with Old Market and south side from junction with Chantry Road to opposite junction with Old Market from 9.30 - 10.00 to 1.30-2.00.





Amend waiting restrictions in High Street, Old Market to Maidstone Road, from 10.30 am -11.00am to 11.00-11.30am.