

THE MAIDSTONE BOROUGH COUNCIL

Land to the rear of Milton Street and Hartnup Street, Milton Street, Maidstone

MBC Ref: 14/503755

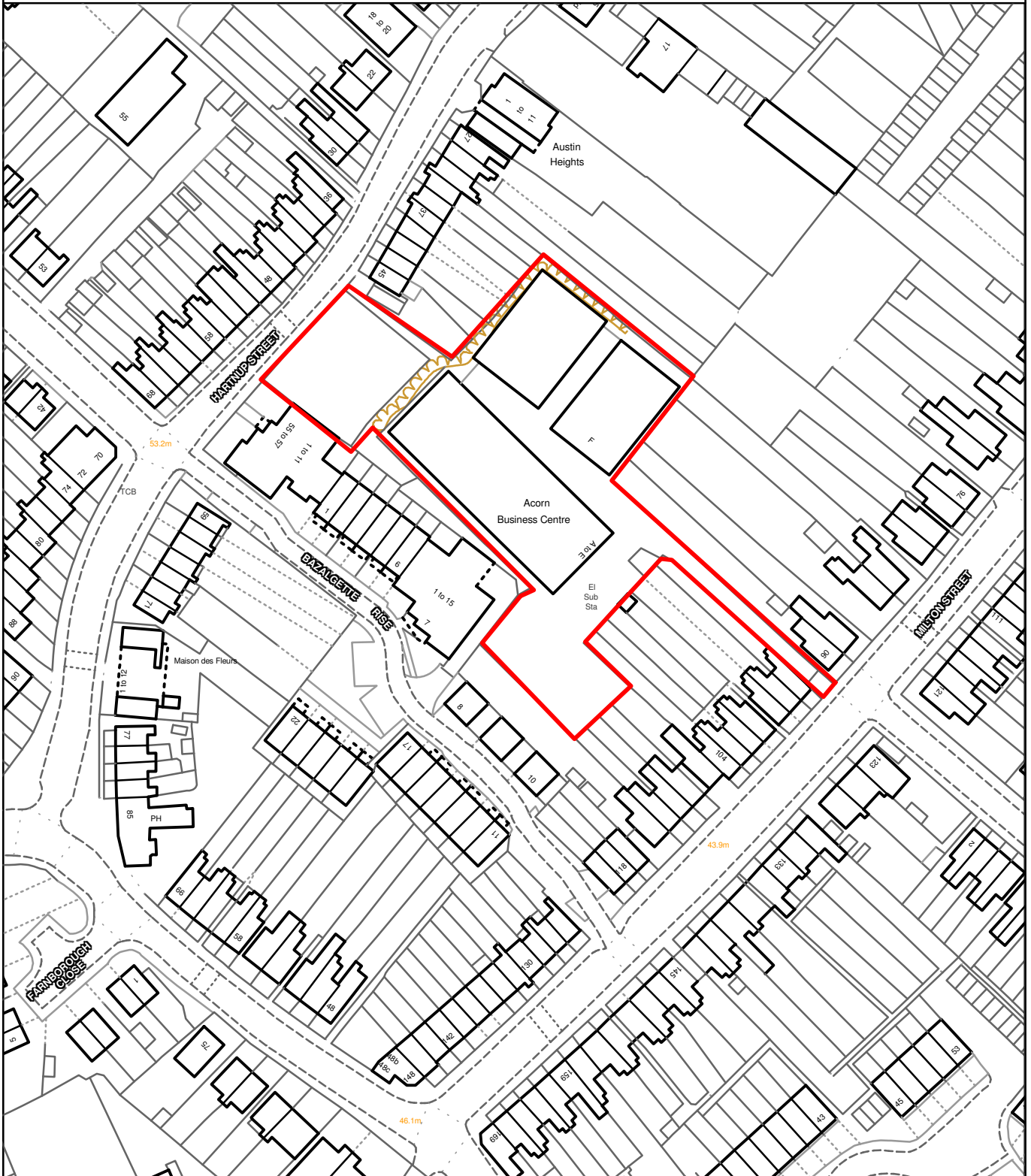

Reproduced from the Ordnance Survey mapping with the permission of the Controller of Her Majesty's Stationary Office ©Crown Copyright. Unauthorised reproduction infringes Crown Copyright and may lead to prosecution or civil proceedings. The Maidstone Borough Council Licence No. 100019636, 2014. Scale 1:2500



Rob Jarman
Head of Planning