

# THE MAIDSTONE BOROUGH COUNCIL

PLANNING APPLICATION NUMBER: MA/10/0170

GRID REF: TQ7955

10 NURSERY AVENUE,  
BEARSTED.

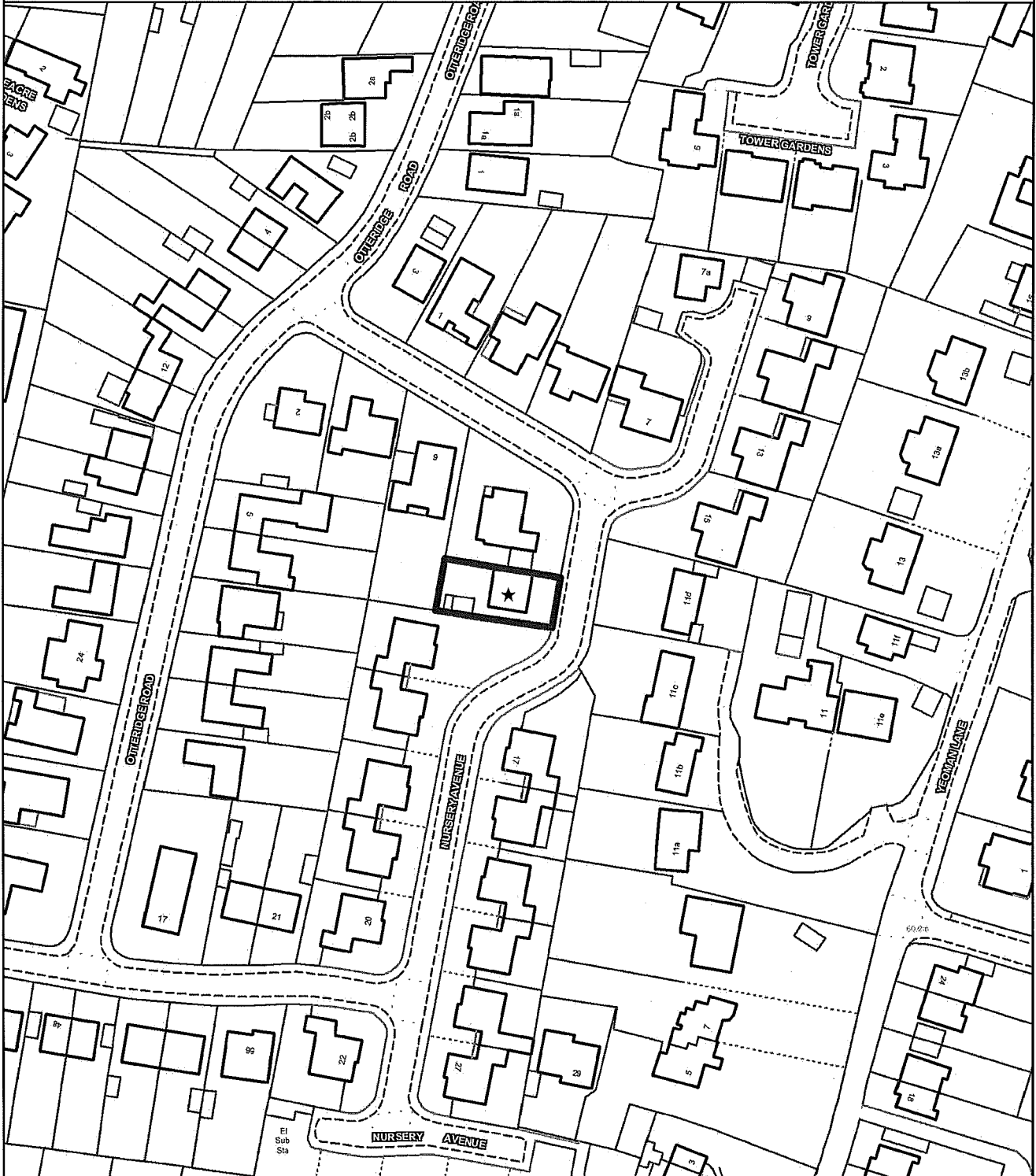

This copy has been produced specifically for Planning and Building Control Purposes only. No further copies may be made. Reproduced from the Ordnance Survey mapping with the permission of the Controller of Her Majesty's Stationary Office ©Crown Copyright. Unauthorised reproduction infringes Crown Copyright and may lead to prosecution or civil proceedings. The Maidstone Borough Council No. 1000019636, 2009. Scale 1:1250



**Alison Broom**  
Director of Prosperity and Regeneration