

NEW 150mm METAL STUD PARTITION FACED EACH SIDE WITH 2nd. 12.5mm PLASTERBOARD WITH JOINTS TAPED AND SEALED. SEE 2nd. CIVILS DRAWING, CEILING BARLEY WHITE TO SALES SIDE ONLY. PARTITIONING TAKEN UP TO STRUCTURAL SOFFIT OR FIRE BARRIER TO BE INSTALLED ABOVE PARTITION. ALL TO PROVIDE MINIMUM ONE HOUR FIRE RESISTANCE. LOW LEVEL PROTECTION TO WALLS TO BE PROVIDED.

Whole of retail area licensed to allow for flexibility of display

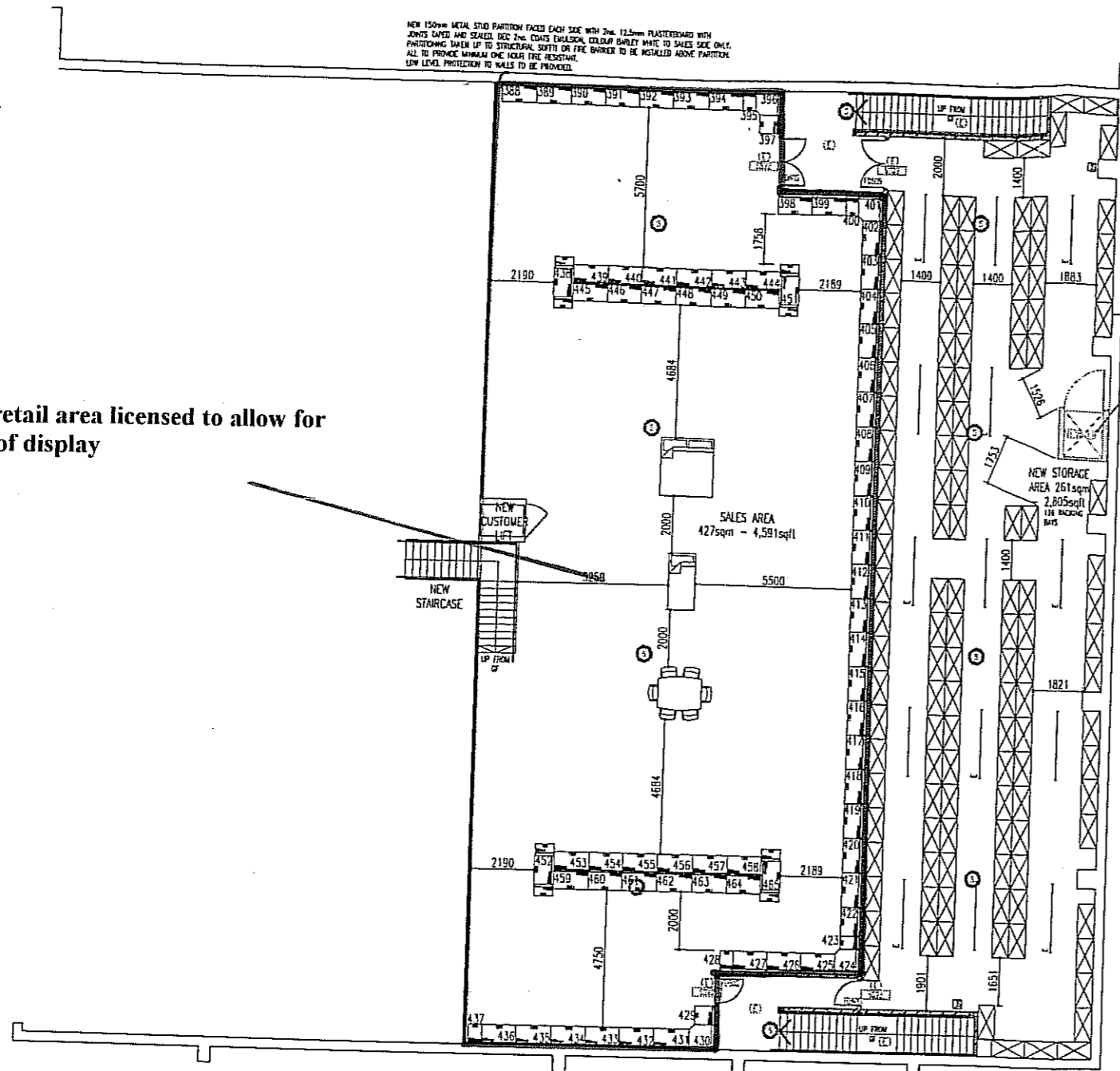

PROPOSED MEZZANINE FLOOR PLAN SCALE 1:100

BUILDING REGS NOTES

- STAIRCASES**
 - ALL EMERGENCY LIGHTING TO BE INSTALLED IN ACCORDANCE WITH BS5266-1:2001, BS 5266-2:1999, BS 5266-3:2004, & (RELAND - (S.312)).
 - FIRE ALARM TO BE INSTALLED IN ACCORDANCE WITH BS5810-1:2002 & BS5810-2:1999 - (S.312)(2000).
 - FIRE ESCAPE DOOR TO BE INSTALLED IN ACCORDANCE WITH BS499-1:2002 (ALSO RELEVANT TO RELAND) AND HEALTH AND SAFETY (SAFETY SIGNS & SIGNALS) REGULATIONS 1996.
- NEW AIRFLAME RESISTANT STAIR TO MEZZANINE**
 - GROUND FLOOR TO MEZZANINE FLOOR HEIGHT = 2045mm
 - NEW STAIR OF 21 RISERS @ 108mm EACH
 - RISERS TO BE MIN. 200mm DEEP
 - NOSINGS OF RISERS TO BE CLEARLY IDENTIFIED
 - INTERMEDIATE RECTANGULAR LANDING AT STEP 14/12
 - STAIRS IN EXCESS OF 1.0m WIDE TO HAVE HANDRAIL ON BOTH SIDES
 - HANDRAIL TO BE MIN. 900mm & MAX. 1000mm ABOVE FINISH FLOOR
- DOOR DOGS**
 - ALL FIRE DOORS TO BE FITTED WITH SMOKE SEALS AND SELF-CLOSING DEVICES
 - ALL FINAL DOOR DOGS TO BE FITTED WITH PANE LATCHES
 - ALL FIRE ESCAPE DOORS TO OPEN IN THE DIRECTION OF ESCAPE TO FINAL EXIT
- COMPARTMENTATION - WALLS BETWEEN SALES & STORAGE**
 - 150mm METAL STUD PARTITION FACED EACH SIDE WITH 2nd. LAYERS 12.5mm PLASTERBOARD WITH JOINTS TAPED AND SEALED. STUD WALL TAKEN UP TO STRUCTURAL SOFFIT OR STUD TAKEN UP TO 375mm ABOVE CEILING LINE AND FIRE BARRIER INSTALLED ABOVE PARTITION IN STRICT ACCORDANCE WITH MANUFACTURERS DETAILS. ALL JUNCTIONS, PENETRATIONS ETC. TO BE SUITABLY JOINTED/SEALED IN ACCORDANCE WITH MANUFACTURERS DETAILS. WALLS AND BARRIERS TO ACHIEVE MINIMUM ONE HOUR FIRE RESISTANCE.
- ALL DOORS WITHIN THE COMPARTMENT WALL TO ACHIEVE MIN. 60 MIN FIRE RESISTANCE. ALL DOORS TO BE FITTED WITH:**
 - SMOKE SEALS
 - SELF-CLOSING DEVICES
- COMPARTMENTATION - MEZZANINE FLOOR**
 - LAGERS OF MEZZANINE FLOOR STRUCTURE TO BE FINISHED WITH FIRE BOARD TO PROVIDE MINIMUM ONE HOUR FIRE RESISTANCE.
- SUSPENDED CEILING JOISTS MAX. 800mm DEEP**
 - CEILING JOISTS IN EXCESS OF 250mm & A MAX. 800mm DEEP TO BE COMPARTMENTALIZED. COMPARTMENTS OF MAX 250mm² AREAS FINISHED WITH MIN. 30 MIN FIRE RESISTANCE VERTICAL FIRE BARRIERS INSTALLED IN STRICT ACCORDANCE WITH MANUFACTURERS DETAILS. ALL JUNCTIONS, PENETRATIONS ETC. TO BE SUITABLY JOINTED/SEALED IN ACCORDANCE WITH MANUFACTURERS DETAILS.
- SUSPENDED CEILING JOISTS IN EXCESS OF 800mm DEEP**
 - ALL CEILING JOISTS IN EXCESS OF 800mm DEEP SHALL BE SPRINKLER PROTECTED. SPRINKLER SYSTEM TO BE INSTALLED IN STRICT ACCORDANCE WITH FIRE ENGINEERS DETAILED DESIGN.
- DOOR SCHEDULE**
 - EXISTING TO BE OVERHAULLED AND MADE TO COMPLY WITH FIRE REGULATIONS
 - ALUM TO REPLACE WHERE NECESSARY. DOOR OPENING FORCES AND EFFICIENT CLEAR HEIGHTS TO BE IN ACCORDANCE WITH PART M OF BUILDING REGULATIONS. DOOR LEADS MUST BE TO THE ESCAPE OR ACTUATION OF THE ALARM OR POWER FAILURE. SUPPLY A FIT ON CLOSERS TO STOPS FACE WITH 600 N 55 CRUSPLATES EACH FACE AND PAIR PUSH PLATES/ PULL HANDLES TO COMPLY WITH FIRE REGULATIONS.
 - ALL DOOR PRESURE TO BE STAINLESS STEEL. THRESHOLD STOPS TO MAKE UP DIFFERENCE IN FLOOR FINISH LEVELS.
- REVISION SCHEDULE**
 - ALL WALL FINISHES TO BE DEC TO CLASS 1.
 - ALL PROMINENT SPALLED STAINLESS STEEL FINISH UNLESS NOTED OTHERWISE AND FIRE RATED DOORS TO HAVE SMOKE SEALS/ INTAKE/EXHAUST STOPS AND SHOULD BE RATED 30/15 OR 60/30 AS APPROPRIATE. UNLESS NOTED OTHERWISE ALL DOORS, FRAMES DEC 2nd. CIVILS DRAWING, BARLEY WHITE.

BAY LEGEND

- DOUBLE END 32 No.
- 1 No.
- 3 No.
- 1200x800mm 16 No.
- 1200x600mm 349 No.
- 1000x600mm 22 No.
- 650x600mm 8 No.
- 450x600mm 6 No.
- 8 No.
- 4 No.
- 9 No.
- 6 No.
- 1 No.

TOTAL: 465 bays
 MAIN BAYS TOTAL: 371 bays
 CIA GROUND FLOOR: 1,261sqm (13,573sqft)
 NET GROUND FLOOR SALES AREA: 1,092sqm (11,759sqft)
 NET GROUND FLOOR STORAGE AREA: 705sqm (751sqft)
 CIA MEZZANINE FLOOR: 743sqm (7,999sqft)
 NET MEZZANINE FLOOR SALES AREA: 261sqm (2,805sqft)
 NET MEZZANINE FLOOR STORAGE AREA: 427sqm (4591sqft)

NOTE: ALL DIMENSIONS SUBJECT TO SURVEY

- RACKING BAYS 150 No.
- FLOWER STAND 1 No.
- UMBRELLA STAND 1 No.
- EMBELLISHMENT STAND 1 No.
- POSTER STAND 1 No.

NOTE: STANDS TO BE POSITIONED IN CONVENIENT LOCATION - NOT TO OBSTRUCT MEANS OF ESCAPE

CERTIFICATION
 ALL CERTIFICATION, INCLUDING ELECTRICAL INSTALLATION, EMERGENCY LIGHTING COMPLETION, FIRE ALARM COMPLETION AND SPRINKLER INSTALLATION (IF APPLICABLE) ARE TO BE DULY COMPLETED AND FORWARDED TO 99P STORES HEAD OFFICE MARKED FOR THE ATTENTION OF THE HEALTH & SAFETY MANAGER, AS A MATTER OF URGENCY ON COMPLETION OF WORKS.

COM RISK ASSESSMENT SUMMARY
 THIS PROJECT HAS BEEN ASSESSED AND WE BELIEVE THERE ARE NO SIGNIFICANT RISKS IN THE DESIGN THAT A COMPETENT SHOPFITTER WOULD NOT BE ABLE TO OVERCOME.

ELECTRICAL LEGEND

- 2400 THIN BATTEN FLUORESCENT DOUBLE STRIP LIGHT FITTING SUSPENDED FROM U/S SLAB
- AS ABOVE WITH 2 HOUR MAINTAINED EMERGENCY FACE
- 2400 THIN BATTEN FLUORESCENT SINGLE STRIP LIGHT FITTING SUSPENDED FROM U/S SLAB
- AS ABOVE WITH 2 HOUR MAINTAINED EMERGENCY FACE
- 1200 THIN BATTEN FLUORESCENT DOUBLE STRIP LIGHT FITTING SUSPENDED FROM U/S SLAB
- AS ABOVE WITH 2 HOUR MAINTAINED EMERGENCY FACE
- 1200 THIN BATTEN FLUORESCENT SINGLE STRIP LIGHT FITTING SUSPENDED FROM U/S SLAB
- AS ABOVE WITH 2 HOUR MAINTAINED EMERGENCY FACE
- 1200x600mm FLUORESCENT FITTING SET FLUSH IN CEILING WITH FOLDED SILVER LOW BRIGNESS CELLULAR DIFFUSER
- AS ABOVE WITH 3 HOUR MAINTAINED EMERGENCY FACE TO BS5266 PART 1
- 1200x300mm RECESSED ASPERMATIC FLUORESCENT LAMPAE WITH DIFFUSER
- CEILING MOUNTED BATTEN LIGHT
- CEILING MOUNTED PENDANT LIGHT
- WAVE VOLTAGE RECESSED DOWNLIGHTER
- 75W RECESSED WHITE LIGHT FITTING WITH WHITE BEZEL
- COMPUTER LINK TO FIRST FLOOR
- TELEPHONE / IPDS / CREDIT CARD
- FAX
- TELEPHONE SHOP LINE
- SWITCHED FUSED SPUR - LOW LEVEL
- SWITCHED FUSED SPUR - MID LEVEL
- SWITCHED FUSED SPUR - HIGH LEVEL
- 15A ABOVE CEILING FOR ILLUMINATED SIGNAGE
- 15A ABOVE CEILING FOR WARM AIR CURTAIN
- MULTI GANG LIGHTING SWITCH
- CEILING MOUNTED MECHANICAL EXTRACT VENT
- WALL MOUNTED MECHANICAL EXTRACT VENT
- CONSUMER UNIT
- SHAKE SWITCHED SOCKET OUTLET - LOW LEVEL
- DOUBLE SWITCHED SOCKET OUTLET - LOW LEVEL
- BT TELEPHONE SOCKET
- SHAKE WAY LIGHT SWITCH
- TWO WAY LIGHT SWITCH
- CEILING MOUNTED SPEAKER
- WALL MOUNTED SPEAKER
- WALL MOUNTED SPEAKER WITH VOLUME CONTROL
- MICROPHONE
- ALARM CONTROL PANEL
- PANIC BUTTONS
- DUAL TECH MOVEMENT SENSOR
- CONTACT
- SETTING PANEL

FIRE LEGEND

- SMOKE DETECTOR TO UNDERSIDE OF CEILING OR SLAB TO COMPLY WITH BS5810 PART 1, CLAUSE 12.2.1
- SMOKE DETECTOR LOCATED IN VOID ABOVE SUSPENDED CEILING TO COMPLY WITH BS5810 PART 1, CLAUSE 12.2.2
- WIRING CONNECTED HEAT DETECTOR WITH BATTERY BACKUP
- MAINTAINED EMERGENCY ESCAPE LIGHTING WITH BATTERY BACKUP
- FIRE ALARM CALL POINT BREAK GLASS FITTING
- FIRE ALARM BELL SOUNDER
- FIRE ALARM BELL SOUNDER/ FLASHING BEACON
- FIRE ALARM CONTROL PANEL TO INTERFACE WITH LANDLORDS SYSTEM
- INTERNALLY ILLUMINATED SUSPENDED FIRE EXIT SIGN WITH FLASHING MAIN LIGHT AND ARROW TO INDICATE DIRECTION. TO COMPLY WITH BS5839
- FIRE ALARM CONTROL PANEL SUPPLY
- 8 LITRE WATER FIRE EXTINGUISHER
- 2kg CO2 FIRE EXTINGUISHER
- FIRE ACTION NOTICE
- SPRINKLER HEAD

FIT-OUT NOTES:

- NEW LIFTED SPACIA 'TRADITIONAL OAK' WOOD FLOORING TO BE INSTALLED.
- EXISTING CEILING & RACKING TO BE REMOVED.
- EXISTING CEILING TILES TO BE RETAINED IF IN GOOD CONDITION AND REPLACED WITH MATCHING EXISTING MATCH DAMAGED/MISSING TO BE CONFIRMED ON SITE.
- EXISTING LIGHTING TO BE RETAINED IF IN GOOD CONDITION AND REPLACED WITH MATCHING EXISTING WHERE DAMAGED/MISSING TO BE CONFIRMED ON SITE.
- DETECTORS, EMERGENCY LIGHTING, BELLS, CALL POINTS, SIGNS & NOTICES TO BE INSTALLED.
- INSTALL MOBA CASH TILLS, ALLOW CABLING FOR A.
- EXISTING GLAZED SHOP FRONT TO BE RETAINED IF IN GOOD CONDITION TO BE CONFIRMED ON SITE.
- HACK ALL EXPOSED WALLS/PRECAST FACES (WITHOUT SKAFFOLD) 2nd. CIVILS DRAWING, CEILING BARLEY WHITE (WHITE STORAGE AREAS NOT DEPOSITED). TO CEILING ALLOW TO SUPPLY AND INSTALL STAINLESS STEEL ALUMINIUM ROSETTES SLAT CEILING BARLEY WHITE TO MATCH WALLS TO SAME HT AS SHELVING BACK PANELS WHERE INSTALLED.
- NEW AIR CONDITIONING UNITS TO BE SUPPLIED AND INSTALLED. NUMBER AND POSITIONS OF A/C CASSETTES AND CONDENSER UNITS TO BE CONFIRMED ON SITE.

A		01.12.11		SALES FLOOR AND STORAGE LAYOUTS AMENDED	
REVISIONS	NO.	DATE	BY	DESCRIPTION	
	1	22.11	WJD	450	
PROJECT		HANDSTONE RETAIL PARK			
TITLE		PROPOSED FIT-OUT DRAWING - MEZZANINE			
DATE	1 NOV '11	SCALE	1:100		
DRAWN BY	LA	CHECKED	HW		

Anthony Rickott Architects Ltd