

**MAIDSTONE BOROUGH COUNCIL**

**JOINT TRANSPORTATION BOARD**

**17 FEBRUARY 2010**

**REPORT OF KCC'S HEAD OF COUNTYWIDE IMPROVEMENTS**

**Report prepared by Andrew Burton, KCC Highway Schemes Manager**

**HIGHWAY IMPROVEMENT SCHEMES 2009-10**

**1.1 For Information**

Members are asked to:

- 1.1.1 **Note** the progress of the highway improvement programme
- 1.1.2 **Endorse** the proposed Mote Park-to-Detling Cycle Route and agree that public consultation on three sections of proposed shared use footway/cycleway illustrated in Appendix B of this report be carried out.
- 1.1.3 **Endorse** the construction of a zebra crossing in Ware Street, Bearsted, as illustrated in Appendix C of this report
- 1.1.4 **Endorse** the construction of a zebra crossing in Castle Road, Allington, as illustrated in Appendix D of this report

**1.2 Background Documents**

- 1.2.1 Item 11, Kent County Council Highways Advisory Board, 8 May 2008, "Transportation and Safety Package Programme 2008-09"
- 1.2.2 Item 7, Kent County Council Highways Advisory Board, 3 March 2009, "Transportation and Safety Package Programme 2009-10"
- 1.2.3 Item 8, Maidstone Joint Transportation Board, 28 January 2009, "Integrated Transport Plan for Maidstone 2009-10 and Beyond"

**2 Discussion**

- 2.1 Appendix A to this report details the progress of each scheme in the highway improvement programme, including previous years' schemes that were not completed by April 2009. Progress to date is summarised and anticipated progress prior to the next meeting of this Board is detailed. Five schemes are considered in more detail in the body of this report as follows:
- 2.2 **Coxheath Traffic Calming.** In the October 2009 half-term, Kent Highway Services (KHS) further revised the traffic calming in Heath Road. These revisions included the removal of two road narrowings, the relocation of the road narrowing near the medical centre, the re-marking of the white lines, cutting back the overhanging vegetation and installing high friction surfacing on the approaches to what are now the first build-outs in the village. Together,

these measures aim to improve the flow of traffic through the village and to reduce the opportunities for aggressive driving. Nonetheless, aware that there remains local dissatisfaction with the scheme, KHS will be carrying out a further scheme review in 2010. The review will centre upon any crashes that have resulted in personal injury being reported to the police; local Members and the Parish Council will be fully involved to identify any further alterations that these statistics may show to be justified. In the meantime, KHS is working with EdF to upgrade the electricity supply along Heath Road to enable all traffic signs at the carriageway narrowings to be illuminated. This work should be completed in spring 2010.

**2.3 Mote Park to Detling, Maidstone – Cycle Route.** As part of the Local Transport Plan, a cycle route between Detling and Mote Park was included in KCC's 2008-09 capital programme. The objective was to create a spine linking Pilgrims Way with Mote Park for use by both leisure and utility cyclists. Difficulties in improving the crossing of New Cut Road (reported to the October 2009 meeting of this Board) delayed the scheme's design and only now has it been developed to the point at which officers are able to report it to Members for consideration. The proposed scheme comprises four elements, illustrated as Appendix B to this report:

- a)** Converting the east side of New Cut Road between the A20 and Grovewood Drive from a footway to unsegregated shared-use cycletrack
- b)** Converting the south side of Grovewood Drive between the New Cut Road and Franklin Drive from a footway to unsegregated shared-use cycletrack
- c)** Converting the north side of Grovewood Drive between Franklin Drive and Weaving Street from a footway to unsegregated shared-use cycletrack
- d)** An on-carriageway signed cycle route along the length of Weaving Street, Hockers Lane and The Street.

Together, these alterations would create a more pleasant and usable utility cycle route that officers consider could be introduced without measurable detriment to other road users. However, elements (a), (b) and (c) require a "footway conversion order" and it is standard practice in Kent for this to be prefaced by a site notice seeking comments from anyone interested in the potential effects of the scheme. Thus if Members are minded to endorse these elements of the scheme a site notice to this effect will be posted and any responses to it reported to a future meeting of this Board. If no responses are received then the footway conversion order will be made without further reference to this Board.

**2.4 Ware Street, Bearsted– Zebra Crossing.**

**2.4.1** As has been previously reported to this Board, perceived danger when crossing Ware Street led Borough Members and Parish Councils to lobby KHS for a formal pedestrian crossing fronting the Edelin Road development. Following this Board's approval of this scheme in October 2009, concern was raised regarding the environmental impact that the crossing would have on adjoining properties. As a result, construction was shelved, and at the last (emergency) meeting of this Board, Members resolved that consultation on a revised scheme offering an alternative location to the one previously agreed be carried out.

- 2.4.2 The consultation took place in January and sought views from local people on whether they would prefer a zebra crossing to be installed in the vicinity of No.96 (the original location) or at the western side of Edelin Road (the revised location).
- 2.4.3 Consultation Letters were distributed to Thurnham and Bearsted Parish Councils, all nearby local Members and the same properties as the initial consultation together with properties within the Edelin Road development. Properties adjoining Ware Street from both Creve Coeur Close and Longfields Drive were also consulted as they would be most affected by the revised location.
- 2.4.4 A total of twenty-one responses were received, all in support of the need for a zebra crossing. Nineteen preferred the revised location, including two of the six residential Ware Street frontagers, The Bell public house and Swift Roofing. Of the local Members, Mr Carter, Mrs Whittle and Cllr Ash support the revised location and Cllr Horne stated that he would like the crossing sited in the location where it will be used the most, minimising pedestrians taking unnecessary risks. Kent Police favour the revised location because it will provide longer reaction times for drivers when approaching the crossing.
- 2.4.5 Although there is no legal requirement for a Council to formally consider an objection to a zebra crossing, it is customary in Kent for Members to be offered the opportunity to review such a scheme in light of any objections that may be received. By agreement with KCC's Cabinet Member for Environment, Highways and Waste, this review is carried out by this Board.
- 2.4.6 Officers advise that whilst the revised location is further away from the busier 'desire line', the detour (eleven metres) is not significant and it is hoped that most pedestrians would prefer to walk this short distance. Moreover, the revised location is on the desire line for those residents of Edelin Road who walk to the shopping facilities at Grove Green.
- 2.4.7 Accordingly, Members are asked to endorse the scheme illustrated as Appendix C to this report. Subject to this endorsement, construction will start on 17 April 2010.
- 2.5 **Castle Road, Allington – Zebra Crossing.** Following an officer-level review of Allington Primary School's pedestrian accessibility, the need for a school crossing patrol in Castle Road was identified. However, this would have necessitated the removal of the central pedestrian refuge outside the shops, disadvantaging many daytime users, many of whom have impaired mobility. Further studies were carried out and these showed there to be a strong case to instead upgrade the existing pedestrian refuge outside the shops to a zebra crossing (illustrated as Appendix D to this report). Of the forecast £24,000 scheme cost, KCC Education would meet £14,000 (this representing the equivalent cost of operating a school crossing patrol). The remaining £10,000 had not been secured at the time of writing but an update will be provided at the meeting. Subject to approval of this Board, and the remaining £10,000 being secured, construction works can start on 1 March 2010
- 2.6 **Oldborough Manor School, Maidstone:** as has been reported to previous meetings of this Board, the proposed redevelopment of Oldborough Manor School in Loose requires KCC to undertake an extensive series of highway improvements. These are illustrated as Appendix E to this report and works are scheduled to start on site this Spring.

## Appendix A: Highway Improvement Scheme Progress

KHS Ref	Location	Description of Works	Current Progress	Anticipated Actions for next 3 months (Prior to next JTB)	Budget 2009 - 10	Forecast Out-turn	Kent Highway Services Contact 08458 247800
MG 74 10 ML	Traffic calming <b>Coxheath</b> -	2006-07 scheme: Speed management measures including physical measures to slow vehicular traffic	Latest modifications completed on schedule, but electricity supply to traffic signs on road narrowings yet to be upgraded	Scheme review due spring 2010- see main body of report	£50K	£25K	Julian Cook
MY 06 02 TD	<b>Mote Park to Detling</b>	Cycle Route	Design complete (see main body of report)	Public consultation on proposed conversion of footway to shared use cyclepath - see main body of report	£8K	£10K	Simon Allsopp
MY 06 07TD	Ware Street, <b>Bearsted</b>	Zebra crossing west of railway bridge ( <b>Thurnham Parish</b> )	Design complete (see main body of report)	Subject to approval of this Board, works will start 19 April 2010	£25K	£28K	Helen Cobby
MY 06 06TD	<b>Fant</b>	Traffic calming (estimated cost £168K, spread over two financial years)	Construction was scheduled to start on 15 February 2010	Was is scheduled to be completed in late April	£85K	£155K in 09-10 £18K in 10-11	Darren Hickman
MY 06 02TD	Town Centre <b>Maidstone</b>	Cycle route improvements in Station Road	<b>Works Completed On Schedule</b>	None – this scheme will no longer be reported to this Board	£30K	£16K	Helen Cobby
EDUC	Castle Road - <b>Allington</b>	Zebra Crossing	Design complete (see main body of report)	Subject to approval of this Board, and £10K of funding being secured, works will start 1 March 2010	£nil	£24K	Helen Cobby
S106	Oldborough Manor School, <b>Maidstone</b>	Traffic signals at A229/ Boughton La; pedestrian crossings in St Saviours Rd Wallis Ave; cycle path along Sutton Rd;	Design complete (see main body of report)	Subject to approval of this Board, and £10K of funding being secured, works will start 1 March 2010	£nil	£24K	Helen Cobby

Appendix B: Proposed Mote Park to Detling Cycle Route – **Heavy Line** Shows Location of Proposed Conversion of Existing Footway to Unsegregated Cycle Path

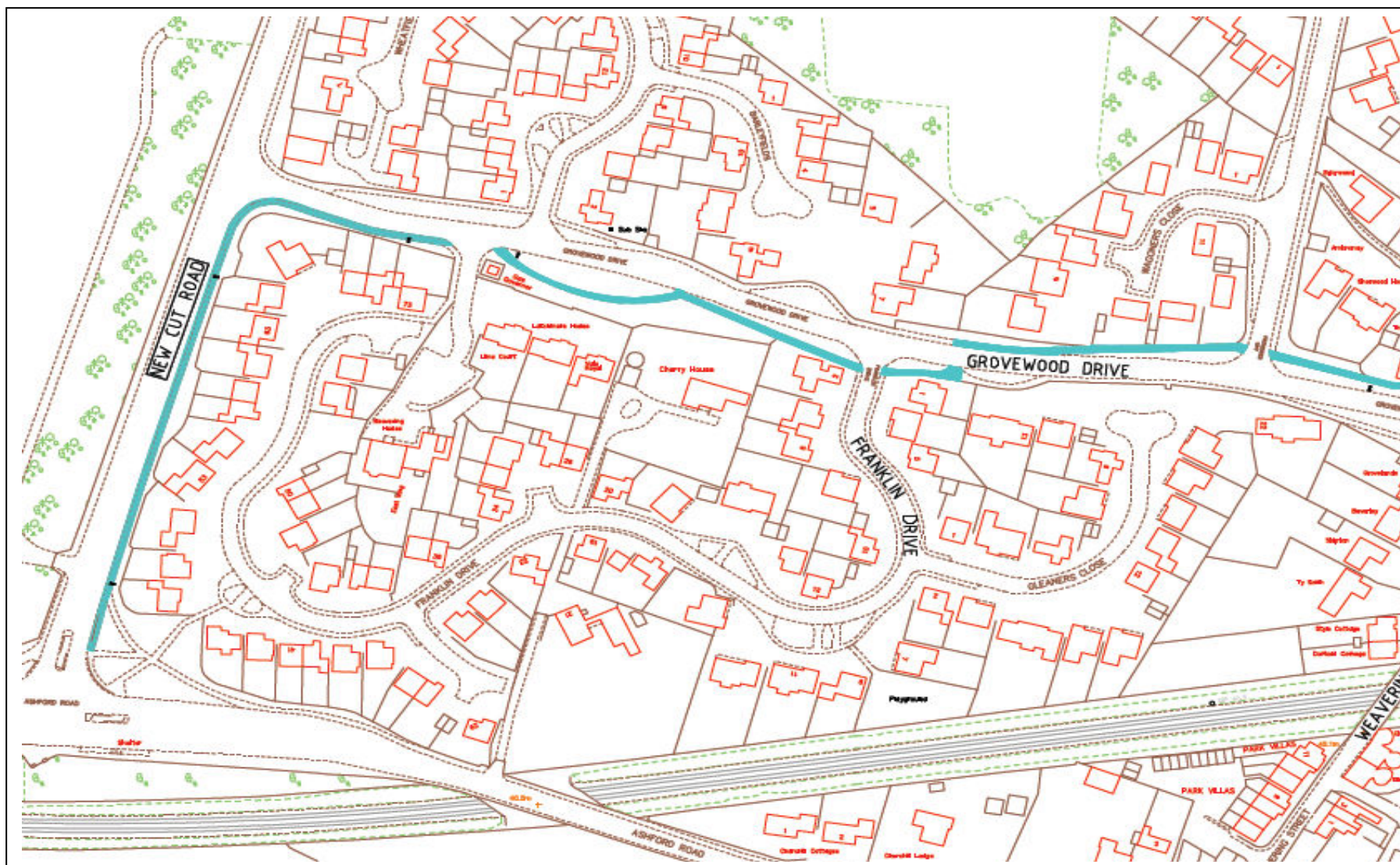



## Appendix C: Ware Street Bearsted – Proposed Zebra Crossing – West of Edelin Road

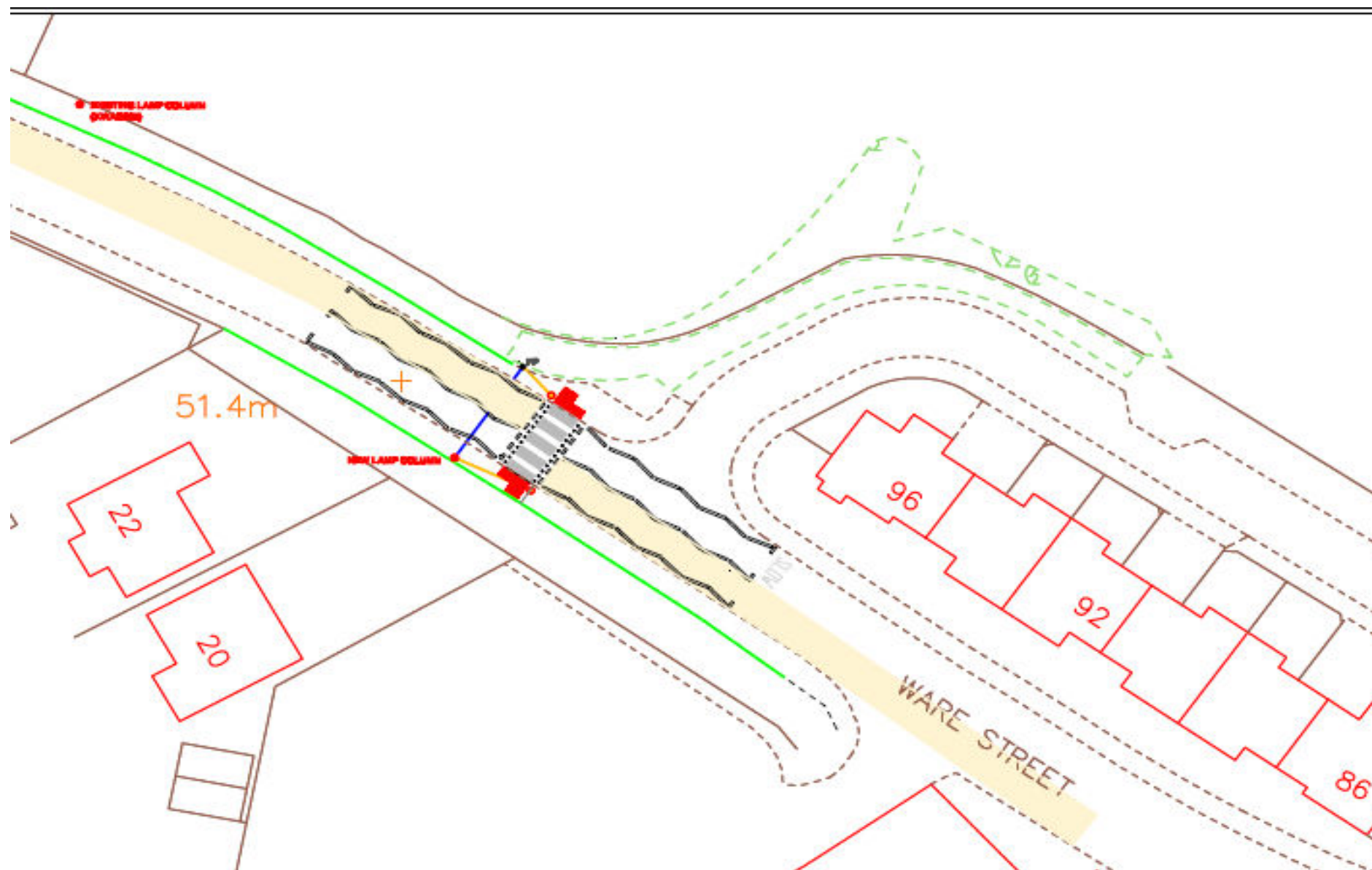

## Appendix D: Castle Road, Allington – Proposed Zebra Crossing

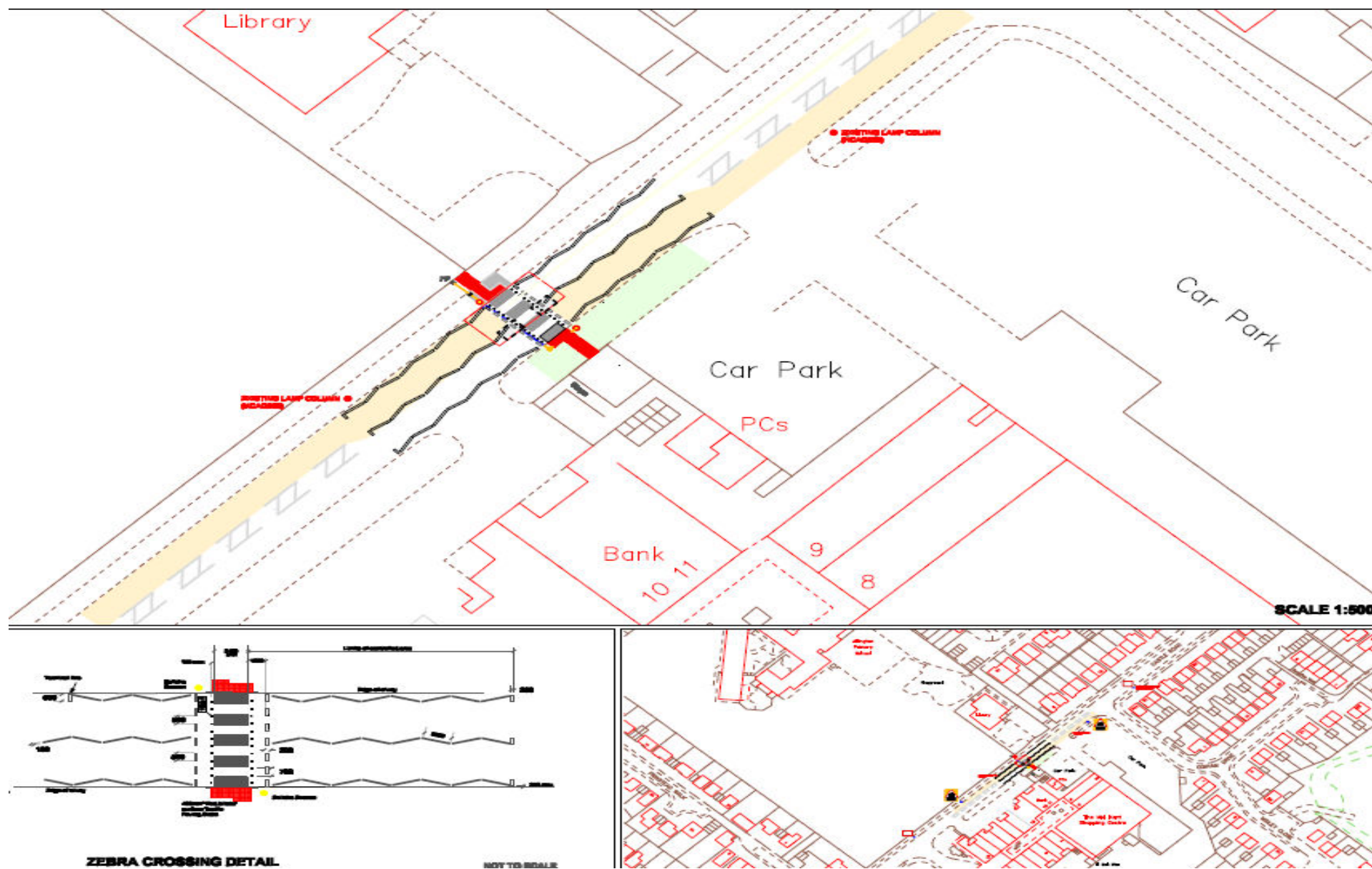



**DO NOT SCALE**

14.07.09 AL TEXT SIZE INCREASED  
09.07.09 AL FIRST ISSUE

REV	DATE	BY	DESCRIPTION	CHK	APP
B	14.07.09	AL	TEXT SIZE INCREASED	NPL	NPL
A	09.07.09	AL	FIRST ISSUE	NPL	NPL

DRAWING STATUS: FOR INFORMATION ONLY

**WSP**  
Kent House, Romney Place, Maidstone, Kent ME15 6JB  
Tel: +44 (0)1622 760800 Fax: +44 (0)1622 760801  
<http://www.wspgroup.com>

CLIENT: K.C.C.

ARCHITECT:

PROJECT: OLDBOROUGH SCHOOL MAIDSTONE

TITLE: LOCATION PLAN & GENERAL ARRANGEMENT

SCALE @ A2	CHECKED	APPROVED
1:10000	NPL	

CAD FILE:	DESIGN DRAWING	DATE:
1405-GA-05 REV B	AL	July 2006

PROJECT No:	DRAWING No:	REV
11111405	1405-GA-05	B

© WSP Group plc