

DO NOT SCALE

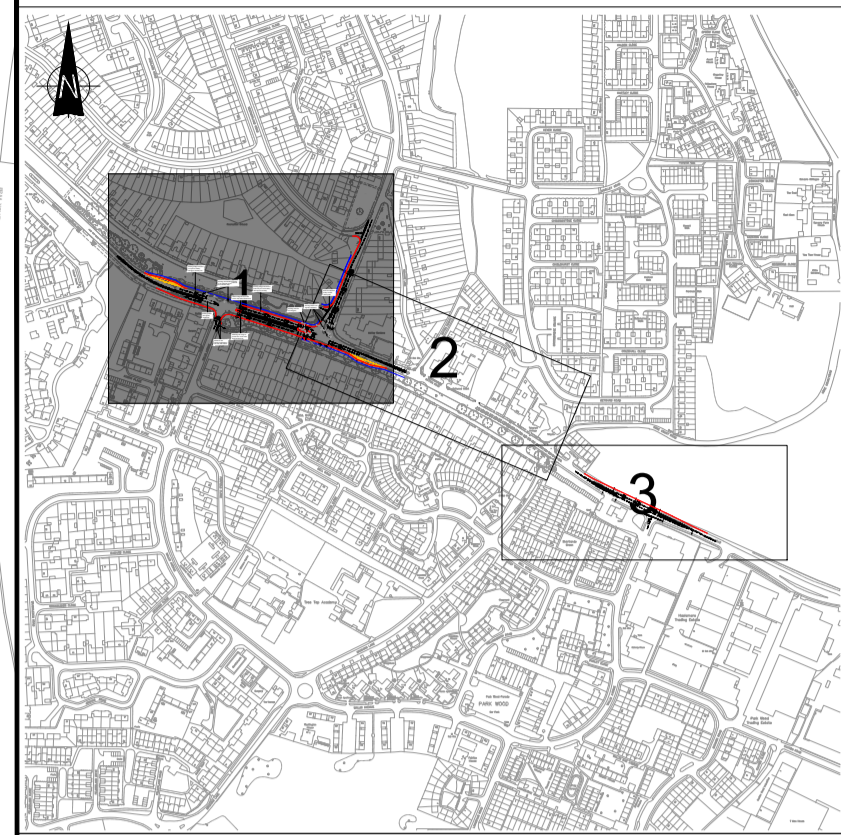

NOTES

- DO NOT SCALE THIS DRAWING.
- ALL DIMENSIONS ARE IN METERS UNLESS OTHERWISE STATED.
- THIS DRAWING SHOULD BE PRINTED IN COLOR.
- THIS DRAWING IS BASED ON TOPOGRAPHICAL SURVEY AND OS BASE DATA SUPPLIED BY KENT COUNTY COUNCIL.
- THIS DRAWING IS BASED ON AN ORIGINAL DESIGN BY AMEY PROVIDED BY KENT COUNTY COUNCIL.
- THIS DRAWING SHALL BE READ IN CONJUNCTION WITH ALL RELEVANT SCHEME DRAWINGS AND SPECIFICATION.
- ALL WORKS TO BE CARRIED OUT IN ACCORDANCE WITH THE DEPARTMENT FOR TRANSPORT SPECIFICATION FOR HIGHWAY WORKS & SUPPLEMENTARY SPECIFICATION DOCUMENTS.
- ALL ROAD MARKINGS AND TRAFFIC SIGN SHALL BE IN ACCORDANCE WITH THE TRAFFIC SIGN MANUAL CHAPTERS 3.4 AND 5.
- ALL PROPOSED KERBS TO TIE IN TO EXISTING KERB LINES AS REQUIRED.
- THE PROPOSED HIGHWAY DESIGN IS SUBJECT TO TRAFFIC MODELING VALIDATION.
- ANY DISCREPANCY WITH THE ORIGINAL SITE SURVEY MUST BE REPORTED IMMEDIATELY TO THE SITE ENGINEER OR KENT COUNCIL PROJECT MANAGER.
- ALL EXISTING ROAD MARKINGS ARE TO BE RENEWED TO TIE IN WITH THE PROPOSED LAYOUT.

KEY

- WSP PROPOSED KERB
- WSP PROPOSED BACK OF FOOTWAY
- WSP PROPOSED ROAD MARKINGS
- RELOCATED TRAFFIC SIGNAL
- EXISTING TRAFFIC SIGNAL TO BE RETAINED

REV	DATE	BY	DESCRIPTION	CHK	APP
1	24/06/2019	MB	REVISED JUNCTION LAYOUT	MB	RB

DRAWING STATUS: S3 - FOR REVIEW



2 Lansdowne Rd, Craydon, CR9 2ER, UK
T+ 44 (0) 208 263 2413
wsp.com

CLIENT: Kent County Council
1st Floor, Invicta House, Maidstone, ME14 1XX



PROJECT: A274 SUTTON ROAD

TITLE: GENERAL ARRANGEMENT - A274 SUTTON ROAD / WILLINGTON STREET JUNCTION

SCALE @ A1: 1:500	CHECKED: MB	APPROVED: RB
PROJECT NO: 70043445	DESIGNED: BV	DATE: 24/06/2019

DRAWING NO: 70043445-A274SR-0100-001	REV: 1
--------------------------------------	--------

© WSP UK Ltd

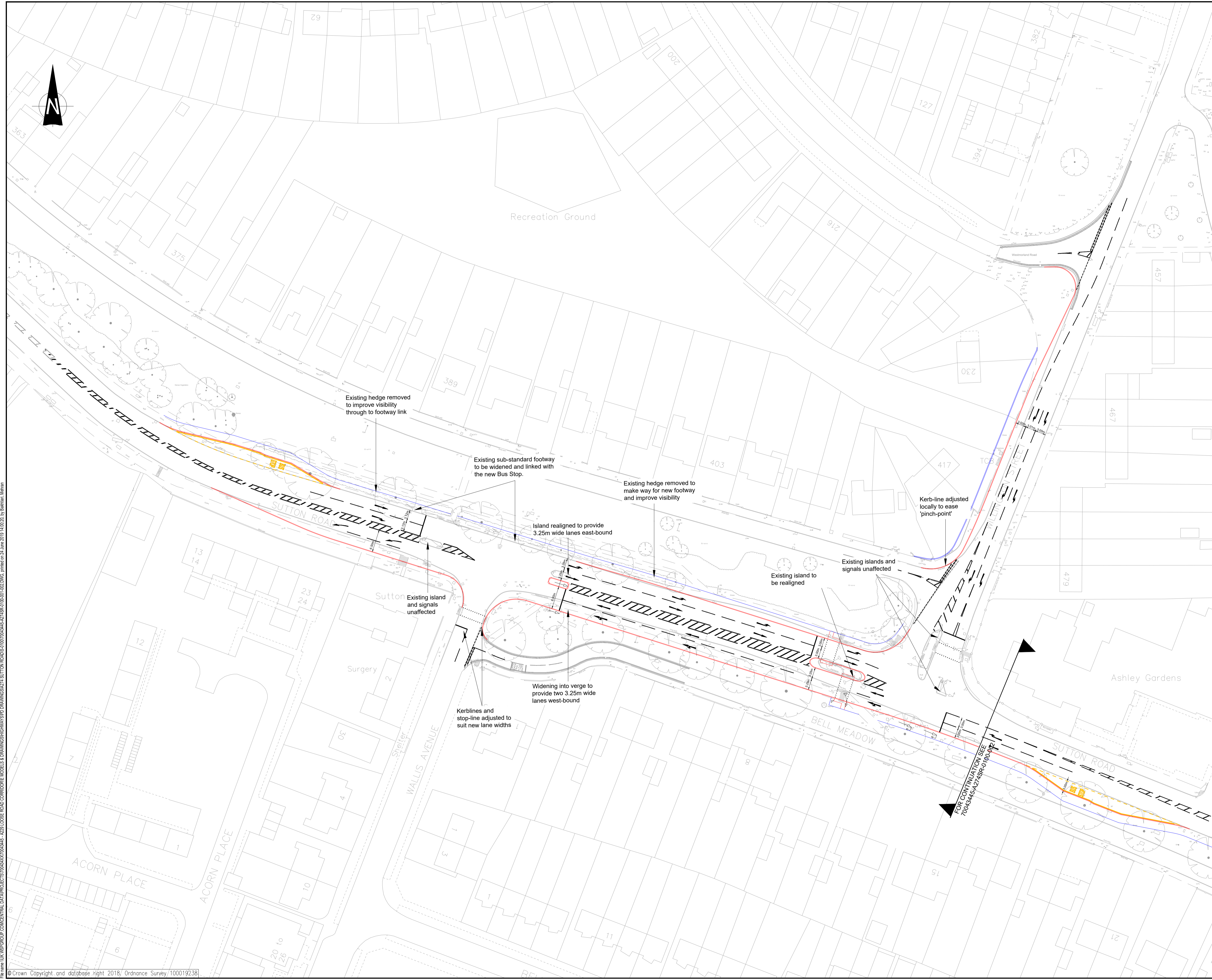

File: \\uk.wspgroup.com\central_data\projects\70043445\A274SR\LOOSE\ROAD\CORRIDOR\MODELS\DRAWINGS\HIGHWAY\WSP_DRAWINGS\A274SR_0100_001_002.DWG, printed on 24 Jun 2019 14:02:20, by Barbara, Meares