

# THE MAIDSTONE BOROUGH COUNCIL

Woodcut Cottage,  
Crismill Lane,  
Thurnham,  
Kent

MBC Ref: MA 14/500282

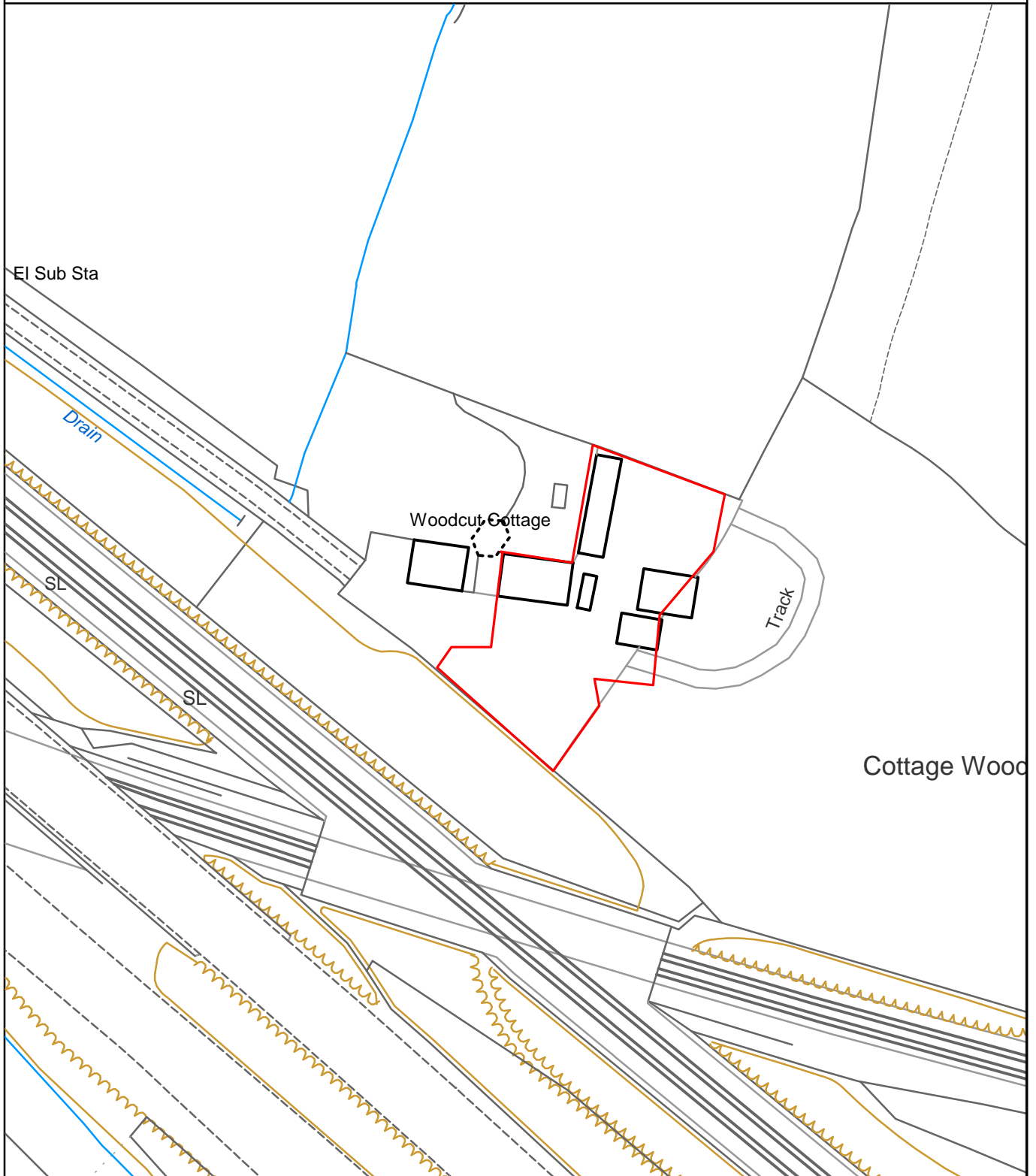

Reproduced from the Ordnance Survey mapping with the permission of the Controller of Her Majesty's Stationary Office ©Crown Copyright. Unauthorised reproduction infringes Crown Copyright and may lead to prosecution or civil proceedings. The Maidstone Borough Council Licence No. 100019636, 2014. Scale 1:1250

"

**Rob Jarman**  
**Head of Planning**